

FF FLAT FLOOD LIGHT SERIES



FFL on Slipfitter



FFM on Trunnion



CALCULATED
LIFETIME
**100,000
HOURS**

FF Series LED Floodlight luminaires provide substantial energy-savings through efficient delivery of light into all areas of parking lots or other large areas. Capable of producing up to 51,000 lumens and is designed for corrosion protection. Expected service life is over 100,000 hours.

Applications: building facades, displays, landscaping, security lighting, parking areas, perimeter, walkways, etc.

Replacement: FFM: 400W MH FFL: 750W -1000W MH

PERFORMANCE INFORMATION

SERIES NUMBER	POWER	DELIVERED LUMENS	CCT
FFM 210 WFL G2 5K	150 Watts	21,150 Lumens	5000K
FFM 210 WFL G2 4K	150 Watts	21,385 Lumens	4000K
FFM 270 WFL G2 5K	200 Watts	27,200 Lumens	5000K
FFM 270 WFL G2 4K	200 Watts	27,275 Lumens	4000K
FFL 350 WFL G2 5K	250 Watts	35,250 Lumens	5000K
FFL 350 WFL G2 4K	250 Watts	34,623 Lumens	4000K
FFL 420 WFL G2 5K	300 Watts	42,300 Lumens	5000K
FFL 420 WFL G2 4K	300 Watts	42,998 Lumens	4000K

Project:	
Catalog No.:	
Fixture Type:	
Notes:	

SPECIFICATIONS

HOUSING

Precision die-cast aluminum housings with integral heat-sink fins. Parting lines dressed for high quality finish

AMBIENT TEMPERATURE

Suitable for use in -40°C to +45°C (-40°F to 113°F)

MOUNTING

Adjustable Slipfitter, York, or Trunnion mount

EFFICACY

Up to 143 lumen's per watt (see individual wattage data)

CCT AND CRI

4000K and 5000K CCT available; 70CRI

OPTICS

Precision molded secondary NEMA 7H X 7V optics produce superior uniformity and maximum pole spacing. Optics sealed to LED package for IP66 protection and UV resistant polycarbonate optical lens.

WARRANTY

10 year limited warranty. Complete warranty terms located at:

www.slgus.com

ELECTRICAL

Voltage: 120/277V standard. 347V-480V optional.

Class 2 Constant Current Drivers with 90% power factor, <20% THD.

Driver efficiency (>90% standard); 50/60Hz; Open/short circuit protection; 10K Surge protector per ANSI/IEEE C62.41.2; NEMA twist lock photocell control optional. Dimming 0-10V driver optional. Motion sensor (PIR) optional

FINISH

Polyester Powder Dark Bronze or White finish. Multi-stage process produces 3 mil thickness for superior corrosion resistance and maximum durability.

CERTIFICATIONS

UL Listed for wet locations. Equivalent to IP66 rating. FCC compliant. RoHs compliant. .

DesignLights Consortium* (DLC) Premium qualified product and DLC qualified product. Not all versions of this product may be DLC Premium qualified or DLC qualified. Please check the DLC Qualified Products List at www.slgus.com/DLC to confirm which versions are qualified.

ORDERING GUIDE

EXAMPLE: FFM 210 WFL G2 4K SFD

Luminaire Type	Lumen Output*	Light Area	Generation	Voltage	CCT	Mounting	Finish	Options
FFM Medium LED Flat Floodlight	210 21,150 Lumens 270 27,200 Lumens	WFL	G2	Standard 120-277V HVV 347-480V	4K 4000K 5K 5000K	SFD Adjustable Slipfitter Mount T Trunnion Mount	Standard: Dark Bronze	Standard No Option N NEMA Twist-lock Photocell Receptacle M2 Dimmable Motion Sensor
FFL Large LED Flat Floodlight	350 35,250 Lumens 420 42,300 Lumens						Custom: W White*	

NOTE: Standard driver operates on any line voltage from 120-277V (50/60 Hz).

*4000K has less lumens.

*** Data as report to DLC, actual test results may vary

****For any Finish color other then Dark Bronze, please call for custom order.



SLG Lighting
10643 W. Airport Blvd. Suite 400, Stafford, Texas 77477
Email: support@slgus.com | Phone: (832) 939-8412 | www.slgus.com

FFV18.09

MOUNTING

SLIPFITTER MOUNT (SFD)

An optional cast aluminum mast arm adapter secures fixture head to nominal 2"(2-3/8"O.D. pipe size) horizontal steel tenon arm.



TRUNNION (T)

Adjustable steel trunnion with mounting holes for flat-surface mounting.

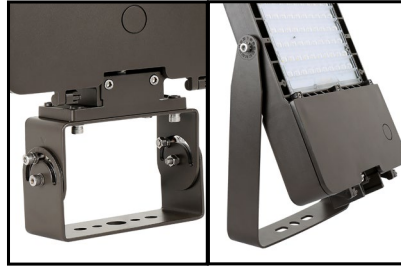

WALL MOUNT (WM)

Easy to install directly to wall mounting with 1/2" conduit wiring or standard J-box mounting.



MOUNTING DIMENSIONS

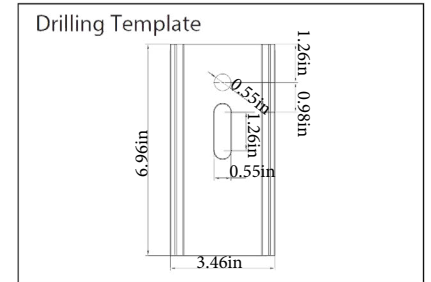
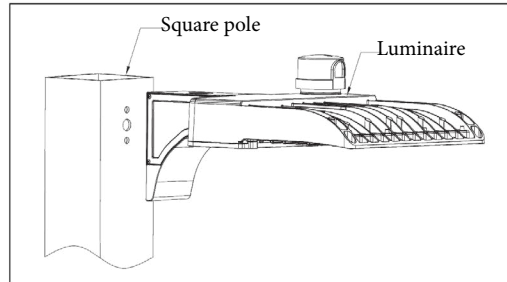
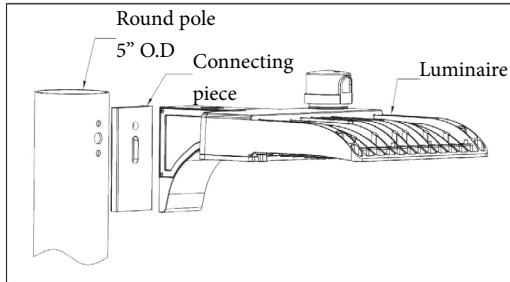

DIMENSIONS

150W&200W (SLIPFITTER)

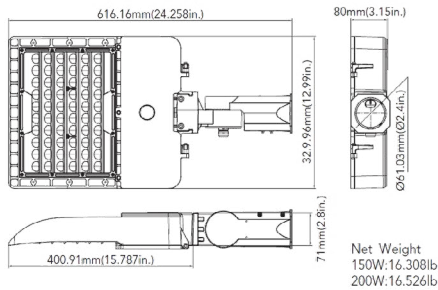

150W&200W (WALL MOUNT)

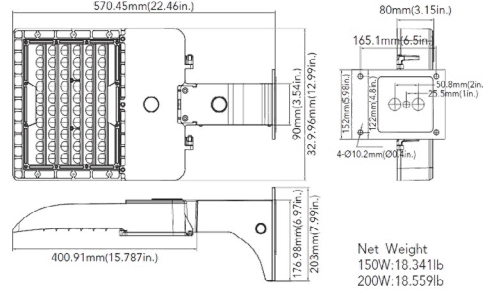

150W&200W (TRUNNION MOUNT)

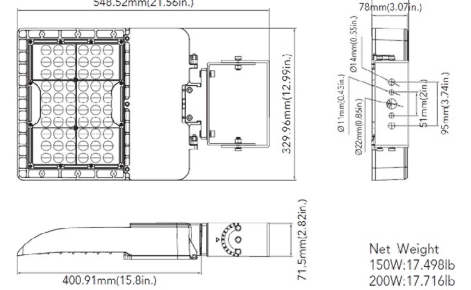

250W&300W (SLIPFITTER)

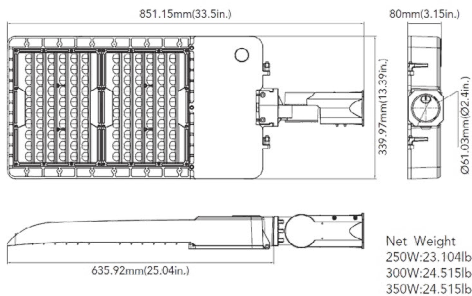

250W&300W (WALL MOUNT)

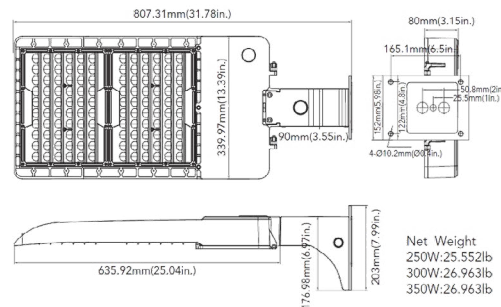

250W&300W (TRUNNION MOUNT)

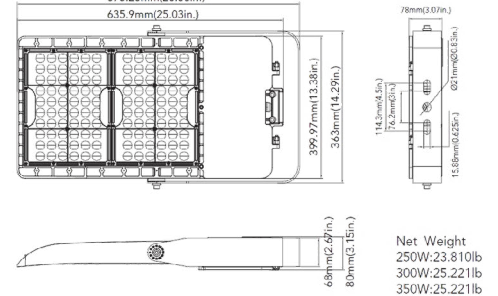

SLG Lighting
10643 W. Airport Blvd. Suite 400, Stafford, Texas 77477
Email: support@slgus.com | Phone: (832) 939-8412 | www.slgus.com

FFV18.09

Flat Flood Light Motion Sensor

Wattstopper



SENSOR

The Wattstopper offer an extensive line of both indoor and outdoor occupancy sensors utilizing a variety of sensing technologies to ensure optimal performance in any environment.

Benefits:

- Comply with energy codes such as Title 24, ASHRAE 90.1, IECC, and other energy codes.
- Enhance green building practices, such as LEED.
- Operating Humidity: 20-90%.
- Operating temperature: -40–167°F (-40–75°C)
- IP66 rated
- Polycarbonate, flame retardant, UV resistant, impact resistant.
- Meets the materials restrictions of RoHS.

Motion Sensor Setting

Motion Sensor	Day Lighting Control	High / Low Dim	Time Delay	Auto On	Auto Off	Load Rating	Current Consumption	Operating Temperature
FSP-212	Yes	Low Dim	30 Sec-30 min	5 fc	10 fc	1/6hp	10mA	-40°F - 158°F

ELECTRICAL LOAD

				Current (A)					
FFM	Series Number	Driver Current (mA)	Wattage	120V	208V	240V	277V	347V	480V
	FFM 210 WFL G2 5K	3900	150 Watts	1.25	0.72	0.63	0.54	0.43	0.31
	FFM 210 WFL G2 4K	3900	150 Watts	1.25	0.72	0.63	0.54	0.43	0.31
	FFM 270 WFL G2 5K	5100	200 Watts	1.66	0.96	0.83	0.72	0.58	0.42
FFL	FFM 270 WFL G2 4K	5100	200 Watts	1.66	0.96	0.83	0.72	0.58	0.42
	FFL 350 WFL G2 5K	6400	250 Watts	2.08	1.20	1.04	0.90	0.72	0.52
	FFL 350 WFL G2 4K	6400	250 Watts	2.08	1.20	1.04	0.90	0.72	0.52
	FFL 420 WFL G2 5K	6000	300 Watts	2.5	1.44	1.25	1.08	0.87	0.62
	FFL 420 WFL G2 4K	6000	300 Watts	2.5	1.44	1.25	1.08	0.87	0.62

PERFORMANCE COMPARISON



Product Series	LED Watts	Lumen Output	Lumens Per/Watt	REPLACES	Voltage	DLC
FFM 210	150W	21,150 Lm	141 Lm/W	400W	120-277V	
FFM 270	200W	27,200 Lm	136 Lm/W	400W	120-277V	
FFL 350	250W	35,250 Lm	141 Lm/W	750W	120-277V	
FFL 420	300W	42,300 Lm	141 Lm/W	1,000W	120-277V	



SLG Lighting





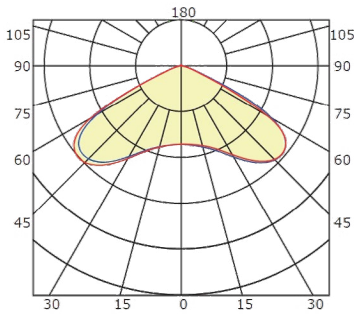

10643 W. Airport Blvd. Suite 400, Stafford, Texas 77477
Email: support@slgus.com | Phone: (832) 939-8412 | www.slgus.com

FFV18.09

PHOTOMETRIC

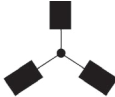

EPA OF FLOOD LIGHT

	Item	Watt							
	FF		1	2 @90°	2 @120°	2 @180°	3 @90°	3 @120°	4 @90°
M	FFM210/FFM270	150W/200W	0.4418	0.7145	0.8813	0.8836	1.0548	1.0135	1.0548
L	FFL350/FFL420	250W/300W	0.5614	0.8471	1.105	1.1228	1.2503	1.2503	1.294

PROJECTED LUMINAIRE MAINTENANCE

OPERATING HOURS					Calculated L70 (Hours)
Ambient Temperature	0	25,000	50,000	100,000	
25°C/ 77°F	1	0.95	0.91	0.81	>214,973

Data references the extrapolated performance projections for the area light base model noted in a 25°C ambient, based on 10,000 hours of LED testing (tested per IESNA LM-80-08 and projected per IESNA TM-21-11)

Ambient Temperature		Lumen Multiplier
0°C	32°F	1.02
10°C	50°F	1.01
20°C	68°F	1.00
25°C	77°F	1.00
30°C	86°F	0.98
40°C	104°F	0.98

LUMEN AMBIENT TEMPERATURE (LAT) MULTIPLIERS:

Use these factors to determine relative lumen output for average ambient temperatures from 0°C-40°C (32°F-104°F)



Scan for more information

