

NRM2-611 / NRM2-612 / NRM2-618

6" Marquise II Reflectors

Source: 15W to 30W LED
900lm to 2500lm

PRODUCT DESCRIPTION

6" Marquise II reflectors includes Cree® COB LEDs with optimized beam spreads, an Unitized Thermal Management (UTM) system and outboard mounted driver allows for cooler operation.

FEATURES

- 5-year Limited Warranty
- Cree® COB LED Technology
- Spot, narrow or flood beam spreads
- 900lm, 1500lm or 2500lm LED packages
- 2700K, 3000K, 3500K and 4000K @ 90+CRI
- Can be used to comply with 2016 Title 24 - part 6 High Efficacy LED light source requirements

CONSTRUCTION

Trim: Aluminum spun reflector with deep set diffused lens for excellent visual comfort while providing high lumen output.

Mounting: Trim includes torsion springs to mount trim securely to housing.

ELECTRICAL

Lumens / Wattage:

L09 = 900lm / 15W; **L15** = 1500lm / 18W;

L25 = 2500lm / 30W

Color Temperature: 2700K, 3000K, 3500K, 4000K

CRI: 90+CRI

Beam Spread: (S) Spot; (M) Narrow Flood; (F) Flood

Operating Temp.: 0°C to 45°C ambient temperature

Dimming: Specified by housing

COMPATIBLE HOUSINGS

Reflectors are compatible with respective Marquise II series housings manufactured by Nora Lighting.

CATALOG NO. DESCRIPTION

NHM2-615	6" Non-IC New Construction (1500lm)
NHM2-625	6" Non-IC New Construction (2500lm)
NHRM2-615	6" Non-IC Remodel (1500lm)
NHRM2-625	6" Non-IC Remodel (2500lm)
NHMIC2-609	6" IC New Construction (900lm)
NHRM2-609	6" IC Remodel (900lm)
NHMIC2-615	6" IC Double Wall (1500lm)
NHMIC2-625	6" IC Double Wall (2500lm)
NFBIC2-6L	6" IC Dedicated Fire Box (900 or 1500lm)

DECO GLASS OPTIONS

NRM2-618 is compatible with up to two decorative glass options sold separately. Each glass includes mounting hardware.

NTG-6B/120 6" Tempered Blue Glass with 4-3/8" Open Center

NTG-6B/80 6" Tempered Blue Glass with 3-1/8" Open Center

NTG-6CF 6" Tempered Clear Glass with Frosted Center

NTG-6FC 6" Tempered Frosted Glass with Clear Center

NTG-6HF 6" Tempered Clear Glass with Frosted Center and 3-1/8" Open Center

LABELS AND LISTINGS

- cULus Listed for Wet Location when used with compatible housing
- ENERGY STAR® certified
- Can be used to comply with 2016 Title 24 - part 6 High Efficacy LED light source requirements
- [5-Year Limited Warranty](#)
- WSEC ASTM E283 for Air-Tight



PRODUCT IMAGES AND DIMENSIONS



NRM2-611 Round Open Reflector

BW, BZ, CO, DW, HZW, NN, WW

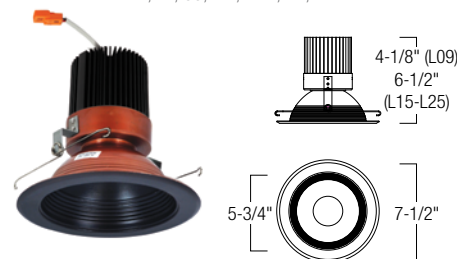

NRM2-612 Round Baffle

BW, BZ, CO, NN, WW

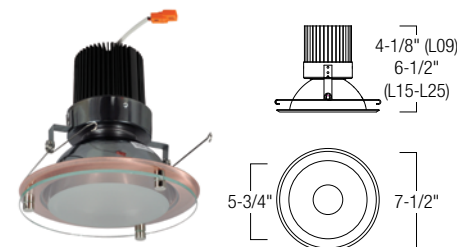

NRM2-618 Decorative Glass Reflector (Specify glass separately)

BW, BZ, CO, DW, HZW, NN, WW

6" Marquise II Reflectors - Dedicated Housing Required

Reflector Type	Lumens / Wattage	Color Temp.	Beam Spread	Finish (see chart below)
NRM2-611 = Round Open Reflector	L09 = 900lm / 15W	27 = 2700K	S = Spot	BW = Black / White Flange
NRM2-612 = Round Baffle	L15 = 1500lm / 18W	30 = 3000K	M = Narrow Flood	BZ = Bronze / Bronze Flange
NRM2-618 = Round Deco Glass* ¹	L25 = 2500lm / 30W	35 = 3500K	F = Flood	CO = Copper / Copper Flange
		40 = 4000K		DW = Diffused Clear / White Flange
				HZW = Haze / White Flange
				NN = Natural Metal / Natural Metal Flange
				WW = White / White Flange

*Deco Glass Option

NTG-6B/120 Tempered Blue Glass with 4-3/8" Open Center

NTG-6B/80 Tempered Blue Glass with 3-1/8" Open Center

NTG-6CF Tempered Clear Glass with Frosted Center

NTG-6FC Tempered Frosted Glass with Clear Center

NTG-6HF Tempered Clear Glass with Frosted Center and 3-1/8" Open Center

¹ Round Deco Glass when used with IC Double Wall housing, available with 1500lm only

Available Trim Finishes

	BW	BZ	CO	DW	HZW	NN	WW
611	•	•	•	•	•	•	•
612	•	•	•			•	•
618	•	•	•	•	•	•	•

Example: **NRM2-611L5230SWW** = 6" Marquise II Round Open Reflector, 1500lm / 18W LED, 3000K, Spot Beam Spread, White Reflector / White Flange

NRM2-614 / NRM2-617 / NRM2-619

6" Marquise II Adjustable Reflectors

Source: 15W to 30W LED
900lm to 2500lm

PRODUCT DESCRIPTION

Marquise II COB Series enhances an established series of downlighting with the latest COB technology by Cree®. The COB allows for better optic control offering 3 beam spreads. Beam spreads focus the light down to the work plane from high ceiling applications.

FEATURES

- 5-year Limited Warranty
- Cree® COB LED Technology
- Spot, narrow or flood beam spreads
- 900lm, 1500lm or 2500lm LED packages
- 2700K, 3000K, 3500K and 4000K @ 90+CRI
- Can be used to comply with 2016 Title 24 - part 6 High Efficacy LED light source requirements

CONSTRUCTION

Trim: Aluminum spun reflector with deep set diffused lens for excellent visual comfort while providing high lumen output.

Mounting: Trim includes torsion springs to mount trim securely to housing.

ELECTRICAL

Lumens / Wattage:

L09 = 900lm / 15W; **L15** = 1500lm / 18W;

L25 = 2500lm / 30W

Color Temperature: 2700K, 3000K, 3500K, 4000K

CRI: 90+CRI

Beam Spread: (S) Spot; **(M)** Narrow Flood; **(F)** Flood

Operating Temp.: 0°C to 45°C ambient temperature

Dimming: Specified by housing

COMPATIBLE HOUSINGS

Reflectors are compatible with respective Marquise II series housings manufactured by Nora Lighting.

CATALOG NO. DESCRIPTION

NHM2-615	6" Non-IC New Construction (1500lm)
NHM2-625	6" Non-IC New Construction (2500lm)
NHRM2-615	6" Non-IC Remodel (1500lm)
NHRM2-625	6" Non-IC Remodel (2500lm)
NHMIC2-609	6" IC New Construction (900lm)
NHRM2-609	6" IC Remodel (900lm)
NHMIC2-615	6" IC Double Wall (1500lm)
NFBIC2-6L	6" IC Dedicated Fire Box (900 or 1500lm)

LABELS AND LISTINGS

- cULus Listed for Damp Location when used with compatible housing
- ENERGY STAR® certified
- Can be used to comply with 2016 Title 24 - part 6 High Efficacy LED light source requirements
- 5-Year Limited Warranty
- WSEC ASTM E283 for Air-Tight



PRODUCT IMAGES AND DIMENSIONS

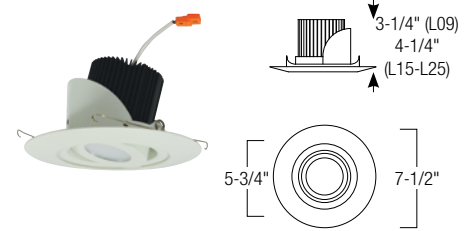

NRM2-614 Surface Adjustable Reflector

B, BZ, C, CO, NN, WW

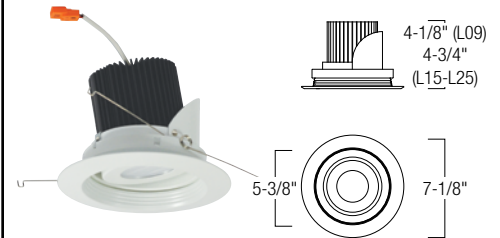

NRM2-617 Regressed Baffle Adjustable

BW, BZ, CO, NN, WW



NRM2-619 Regressed Reflector Adjustable

BW, BZ, CO, HZW, NN, WW

6" Adjustable Marquise II Reflectors - Dedicated Housing Required

Reflector Type	Lumens / Wattage	Color Temp.	Beam Spread	Finish (see chart below)
NRM2-614 = Surface Adjustable	L09 = 900lm / 15W	27 = 2700K	S = Spot	B = Black
NRM2-617 = Regress Baffle Adj.	L15 = 1500lm / 18W	30 = 3000K	M = Narrow Flood	BW = Black / White Flange
NRM2-619 = Regress Reflector Adj.	L25 = 2500lm / 30W	35 = 3500K	F = Flood	BZ = Bronze / Bronze Flange
		40 = 4000K		C = Chrome
				CO = Copper / Copper Flange
				HZW = Haze / White Flange
				NN = Natural Metal / Natural Metal Flange
				WW = White / White Flange

Available Trim Finishes

	B	BW	BZ	C	CO	HZW	NN	WW
614	•		•	•	•		•	•
617		•	•		•		•	•
619		•	•		•	•	•	•

Example: **NRM2-614L1530SBZ** = 6" Marquise II Surface Adjustable, 1500lm / 18W LED, 3000K, Spot Beam Spread, Bronze Finish

NHMICD2-615 / NHMICD-625

6" Marquise II IC Air-Tight Double Wall New Construction Housing

Source: 18W to 30W LED
1500lm to 2500lm

PRODUCT DESCRIPTION

Dedicated new construction housing for use in insulated ceilings can be in direct contact with thermal insulation. Air-tight construction provides energy savings by reducing the flow of air through the ceiling.

CONSTRUCTION

Plaster Frame: 0.040 steel frame with integral bar hanger brackets. Brackets can accommodate longer 27" accessory flat bar hangers. Brackets run along all sides of frame to allow bar hangers to be run parallel or perpendicular to junction box.

Housing: 0.040 aluminum housing with riveted cap adjusts from 3/8" to 7/8". Spring brackets accept torsion wing trim springs; slots on socket plate surface accept standard coil springs.

Air Flow Restriction: Housing has factory installed gaskets to restrict airflow from room into ceiling plenum to <2CFM (cubic feet per minute) in accordance with ASTM-283 Air-Tight requirements.

Clearance: "IC" Insulated ceiling housings are direct contact rated; no minimum clearance is required.

Bar Hangers: Two 13-3/4" to 24-1/2" adjustable bar hangers with captive nails are included on frame. Bar hangers are parallel to junction box, but can be repositioned 90° perpendicular to junction box if desired. "L" Shaped bar hanger foot to align to bottom of construction joist. A T-Bar notch allow for easy installation in a suspended ceiling.

Junction Box: Prewired 25 cubic inch 0.064" thick galvanized steel, with five 1/2", two 3/4" knockouts, four Romex® pryouts, and snap on covers. All leads are #18AWG wire, the ground wire is connected to the bottom, and quick connectors are supplied on all leads. Through branch circuit wiring, (4-in, 4-out).

ELECTRICAL

Input Voltage: 120V or 277V

Lumens / Wattage:

NHMIC2-615 = 1500lm / 18W

NHMIC2-625 = 2500lm / 30W

Operating Temp.: 0°C to 45°C ambient temperature

Dimming: Triac, ELV or 0-10V dimming

[Click Here](#) or check complete dimmer list at www.Noralighting.com in the "Compatibility" page under "Resources" tab

COMPATIBLE REFLECTORS

CATALOG NO. DESCRIPTION

NRM2-611	6" Round Open Reflector
NRM2-612	6" Round Baffle
NRM2-618	6" Round Deco Glass (1500lm only)
NRM2-614	6" Round Surface Adjustable
NRM2-617	6" Round Regress Baffle Adjustable
NRM2-619	6" Round Regress Reflector Adjustable

LABELS AND LISTINGS

- cULus Listed for Damp Location w/ Feed Through
- cULus Wet Listed (Only with designated trims)
- Meets or exceeds ASTM-283 Air-Tight Requirements



PRODUCT IMAGES AND DIMENSIONS

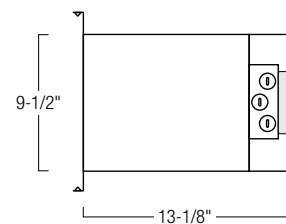
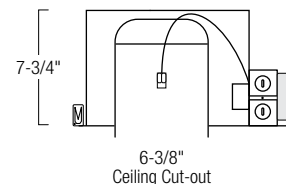

6" Marquise II IC Air-Tight Double Wall New Construction Housing - Compatible with Marquise II Reflectors

Installation Type / Lumens / Wattage	Driver
NHMICD2-615 = IC / 1500lm / 18W	LE2 = 277V Input; 0-10V dimming
NHMICD2-625 = IC / 2500lm / 30W	LE3 = 120V Input; Triac/ELV dimming
	LE5 = 120V Input; 0-10V dimming

Example: **NHMICD2-625LE5** = 6" Marquise II IC Air-Tight Double Wall New Construction Housing, 2500lm / 30W LED, 120V Input

NHM2-615 / NHM2-625 / NHMIC2-609

6" Marquise II Air-Tight New Construction Housing

Source: 15W to 30W LED

900lm to 2500lm

PRODUCT DESCRIPTION

Dedicated new construction housing for installation in Non-IC or insulated ceilings, must specify. Air-tight construction provides energy savings by reducing the flow of air through the ceiling.

CONSTRUCTION

Plaster Frame: 0.040 steel frame with integral bar hanger brackets. Brackets can accommodate longer 27" accessory flat bar hangers. Brackets run along all sides of frame to allow bar hangers to be run parallel or perpendicular to junction box.

Housing: 0.040 aluminum one-piece can. Adjustable ceiling thickness from 3/8" to 7/8".

Air Flow Restriction: Housing has factory installed gaskets to restrict airflow from room into ceiling plenum to <2CFM (cubic feet per minute) in accordance with ASTM-283 Air-Tight requirements.

Bar Hangers: Two 13-3/4" to 24-1/2" adjustable bar hangers with captive nails are included on frame. Bar hangers are parallel to junction box, but can be repositioned 90° perpendicular to junction box if desired. "L" Shaped bar hanger foot to align to bottom of construction joist. A T-Bar notch allow for easy installation in a suspended ceiling.

Junction Box: Prewired 25 cubic inch 0.064" thick galvanized steel, with seven 1/2" knockouts, four Romex® pryouts, and snap on covers. All leads are #18AWG wire, the ground wire is connected to the bottom, and quick connectors are supplied on all leads. Through branch circuit wiring, (4-in, 4-out).

CLEARANCE

Non-IC: Non-Insulated housings require a minimum clearance of 3" from thermal insulation and 1/2" from adjacent building components.

IC: Insulated ceiling housings are direct contact rated; no minimum clearance is required.

ELECTRICAL

Input Voltage: 120V or 277V

Lumens / Wattage:

NHMIC2-609 = 900lm / 15W

NHM2-615 = 1500lm / 18W

NHM2-625 = 2500lm / 30W

Operating Temp.: 0°C to 45°C ambient temperature

Dimming: Triac, ELV or 0-10V dimming

[Click Here](#) or check complete dimmer list at www.NoraLighting.com in the "Compatibility" page under "Resources" tab

Emergency LED Driver (BSL17C-C2)

- Up to 7.5W emergency illumination with LEDs.
- Illumination Time: 90min
- Voltage: 120/277 VAC, 60Hz
- Output Voltage: 15.0-50.0 VDC
- Available with remote test switch, must specify

COMPATIBLE REFLECTORS

CATALOG NO.	DESCRIPTION
NRM2-611	6" Round Open Reflector
NRM2-612	6" Round Baffle
NRM2-618	6" Round Deco Glass
NRM2-614	6" Round Surface Adjustable
NRM2-617	6" Round Regress Baffle Adjustable
NRM2-619	6" Round Regress Reflector Adjustable

LABELS AND LISTINGS

- cULus Listed for Damp Location w/ Feed Through
- cULus Wet Listed (Only with designated trims)
- Meets or exceeds ASTM-283 Air-Tight Requirements



PRODUCT IMAGES AND DIMENSIONS

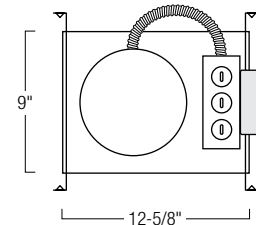
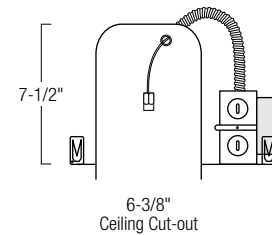

6" Marquise II Air-Tight New Construction Housing - Compatible with Marquise II Reflectors

Installation Type / Lumens / Wattage	Driver / Dimming	Emergency
NHMIC2-609 = IC / 900lm / 15W	LE2 = 277V Input; 0-10V dimming	EM - Emergency Pack w/ Remote Test Switch
NHM2-615 = Non-IC / 1500lm / 18W	LE3 = 120V Input; Triac/ELV dimming	
NHM2-625 = Non-IC / 2500lm / 30W	LE5 = 120V Input; 0-10V dimming	

Example: **NHMIC2-609LE5** = 6" Marquise II IC Air-Tight New Construction Housing, 900lm / 15W LED, 120V Input

NHRM2-615 / NHRM2-625 / NHRMIC2-609

6" Marquise II Air-Tight Remodel Housing

Source: 15W to 30W LED
900lm to 2500lm

PRODUCT DESCRIPTION

Dedicated remodel housing for use in Non-IC or insulated ceilings, must specify. Air-tight construction provides energy savings by reducing the flow of air through the ceiling.

CONSTRUCTION

Housing: 0.040 aluminum housing adjusts to a maximum ceiling thickness of 5/8" (16mm). Housing terminates at a 1/4" ceiling flange for even positioning of housing angle within the ceiling. Structural arm consists of 0.050 steel and connects to housing with j-box and ballast. Integral springs brackets provided.

Air Flow Restriction: Housing has factory installed gaskets to restrict airflow from room into ceiling plenum to <2CFM (cubic feet per minute) in accordance with ASTM-283 Air-Tight requirements.

Mounting: Four high tension tempered steel springs secure remodel housing to 5/8" thick (max) ceiling (Hole cutout template provided for convenience).

Junction Box: Prewired 25 cubic inch 0.064" thick galvanized steel, with five 1/2", two 3/4" knockouts, four Romex® pryouts, and snap on covers. All leads are #18AWG wire, the ground wire is connected to the bottom, and quick connectors are supplied on all leads. Through branch circuit wiring, (4-in, 4-out).

CLEARANCE

Non-IC: Non-Insulated housings require a minimum clearance of 3" from thermal insulation and 1/2" from adjacent building components.

IC: Insulated ceiling housings are direct contact rated; no minimum clearance is required.

ELECTRICAL

Input Voltage: 120V or 277V

Lumens / Wattage:

NHRMIC2-609 = 900lm / 15W

NHRM2-615 = 1500lm / 18W

NHRM2-625 = 2500lm / 30W

Operating Temp.: 0°C to 45°C ambient temperature

Dimming: Triac, ELV or 0-10V dimming

[Click Here](#) or check complete dimmer list at www.NoraLighting.com in the "Compatibility" page under "Resources" tab

COMPATIBLE REFLECTORS

CATALOG NO. DESCRIPTION

NRM2-611	6" Round Open Reflector
NRM2-612	6" Round Baffle
NRM2-618	6" Round Deco Glass
NRM2-614	6" Round Surface Adjustable
NRM2-617	6" Round Regress Baffle Adjustable
NRM2-619	6" Round Regress Reflector Adjustable

LABELS AND LISTINGS

- cULus Listed for Damp Location w/ Feed Through
- cULus Wet Listed (Only with designated trims)
- Meets or exceeds ASTM-283 Air-Tight Requirements



PRODUCT IMAGES AND DIMENSIONS

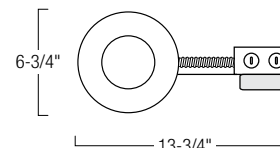
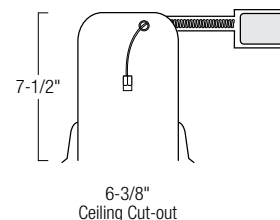

6" Marquise II Air-Tight Remodel Housing - Compatible with Marquise II Reflectors

Installation Type / Lumens / Wattage	Driver
NHRMIC2-609 = IC / 900lm / 15W	LE2 = 277V Input; 0-10V dimming
NHRM2-615 = Non-IC / 1500lm / 18W	LE3 = 120V Input; Triac/ELV dimming
NHRM2-625 = Non-IC / 2500lm / 26W	LE5 = 120V Input; 0-10V dimming

Example: **NHRMIC2-609LE5** = 6" Marquise II IC Air-Tight Remodel Housing, 900lm / 15W LED, 120V Input

NFBIC2-6L09AT / NFBIC2-6L15AT

6" Marquise II IC Air-Tight Housing - 2 Hour Fire & Sound Dampening Rated

Source: 15W to 18W LED
900lm to 1500lm

PRODUCT DESCRIPTION

Specification grade fire-rated new construction housing. The double wall fixture incorporates a non-combustible fiber insulation to prevent passage of flames, toxic gases, ignitable gasses into ceiling plenums. The cULus listed housing is rated for a minimum of 2 hours protection. The noncombustible fiber fill also acts as sound deadening material eliminating the transfer of sound between floors. Suitable for commercial, multi-family and residential applications.

FEATURES

- Rated for direct contact with insulation
- cULus classified 2 Hour Fire Rating
- cULus Wet Listed (Only with designated trims)
- cULus listed for damp location and through branch circuit wiring
- Quick connect provided
- 24-1/2" Bar hangers with captive nails and alignment foot
- Accommodates 1-3/4" maximum ceiling thickness

CONSTRUCTION

Plaster Frame: High quality 0.03" steel die cut one piece frame.

Housing: Die formed 20 guage galvanized steel construction. Housing interior is comprised of a flexible non-combustible insulation.

Air Flow Restriction: Housing has factory installed gaskets to restrict airflow from room into ceiling plenum to <2CFM (cubic feet per minute) in accordance with ASTM-283 Air-Tight requirements.

Bar Hangers: Two 13-3/4" to 24-1/2" adjustable bar hangers with captive nails are included on frame. Bar hangers are parallel to junction box, but can be repositioned 90° perpendicular to junction box if desired. "L" Shaped bar hanger foot to align to bottom of construction joist. A T-Bar notch allow for easy installation in a suspended ceiling.

Junction Box: Prewired 0.03" thick galvanized steel, with seven 1/2" knockouts, four Romex® pryouts, and snap on covers. All leads are #18AWG wire, the ground wire is connected to the bottom, and quick connectors are supplied on all leads. Through branch circuit wiring, (4-in, 4-out).

Quick Connect Feature: Housing contains three UL approved quick connections that allow insertion of 1/4" stripped solid or tinned standard conductors to be inserted into the connector. Connectors are pre-attached to fixture power, common, and ground circuits.

Thermal Protector: Standard UL thermal protector rated for 90°C is affixed to inner top surface of housing.

Installation: Number of luminaires not to exceed the ratio, one per 25sq ft of the total ceiling area, with minimum separation of 3ft between luminaires.

ELECTRICAL

Input Voltage: 120V or 277V

Lumens / Wattage:

L09 = 900lm / 15W; **L15** = 1500lm / 18W

Operating Temp.: 0°C to 45°C ambient temperature

Dimming: Triac, ELV or 0-10V dimming

[Click Here](#) or check complete dimmer list at www.NoraLighting.com in the "Compatibility" page under "Resources" tab

COMPATIBLE REFLECTORS

CATALOG NO. DESCRIPTION

NRM2-611	6" Round Open Reflector
NRM2-612	6" Round Baffle
NRM2-618	6" Round Deco Glass
NRM2-614	6" Round Surface Adjustable
NRM2-617	6" Round Regress Baffle Adjustable
NRM2-619	6" Round Regress Reflector Adjustable

LABELS AND LISTINGS

- UL Classified. Two Hour Fire Rating
- cULus Listed for Damp Location w/ Feed Through
- cULus Wet Listed (Only with designated trims)
- Meets or exceeds ASTM-283 Air-Tight Requirements
- ANSI/UL 263
- ANSI/UL 1598



PRODUCT IMAGES AND DIMENSIONS

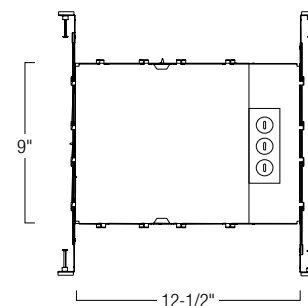
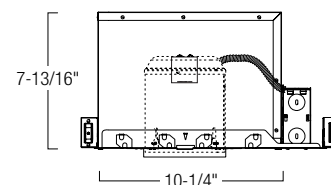

6" Marquise II LED Firebox - Compatible with Marquise II Reflectors

Installation Type / Lumens / Wattage	Driver
NFBIC2-6L09AT = IC / 900lm / 15W	2 = 277V Input; 0-10V dimming
NFBIC2-6L15AT = IC / 1500lm / 18W	3 = 120V Input; Triac/ELV dimming
	5 = 120V Input; 0-10V dimming

Example: **NFBIC2-6L15AT5** = 6" Marquise II LED Firebox Housing, 1500lm / 18W LED, 120V Input

PHOTOMETRICS

6" Marquise II Series

Test Information

Test Number: NTR11040
Part Number: NRM2-611L2540SWW
Beam Spread: Spot
Lumens: 2449lm
Wattage: 29W
Efficacy: 84lpw
CCT / CRI: 4000K / 90 CRI
Spacing Criteria (0°-180): 0.6
Spacing Criteria (90°-270): 0.58

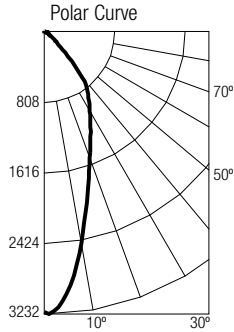

Illuminance at a Distance

Distance from Luminaire	FC at Nadir	Beam Diameter
6'	89.2fc	4'-1"
9'	39.6fc	6'-2"
12'	22.3fc	8'-4"
15'	14.3fc	10'-4"
18'	9.9fc	12'-5"

Zonal Lumen Summary

Zone	Lumens	% Luminaire
0-30	1383	56.5
0-40	1929	78.7
0-60	2322	94.8
0-90	2432	99.3
90-180	18	0.7
0-180	2450	100

Candela Table

Vertical Angles	Candela
0	3211
5	3000
15	1921
25	1260
35	878
45	346

Test Information

Test Number: NTR11039
Part Number: NRM2-611L2540MWW
Beam Spread: Narrow Flood
Lumens: 2445lm
Wattage: 29W
Efficacy: 84lpw
CCT / CRI: 4000K / 90 CRI
Spacing Criteria (0°-180): 0.86
Spacing Criteria (90°-270): 0.86

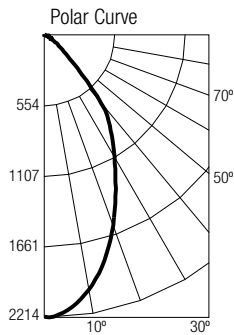

Illuminance at a Distance

Distance from Luminaire	FC at Nadir	Beam Diameter
6'	61.4fc	6'-11"
9'	27.3fc	10'-5"
12'	15.4fc	13'-11"
15'	9.8fc	17'-4"
18'	6.8fc	20'-10"

Zonal Lumen Summary

Zone	Lumens	% Luminaire
0-30	1322	54.1
0-40	1891	77.3
0-60	2314	94.6
0-90	2427	99.3
90-180	0	0
0-180	2445	100

Candela Table

Vertical Angles	Candela
0	2211
5	2156
15	1831
25	1334
35	917
45	378

Test Information

Test Number: NTR11038
Part Number: NRM2-611L2540FWW
Beam Spread: Flood
Lumens: 2030lm
Wattage: 29W
Efficacy: 70lpw
CCT / CRI: 4000K / 90 CRI
Spacing Criteria (0°-180): 1.12
Spacing Criteria (90°-270): 1.12

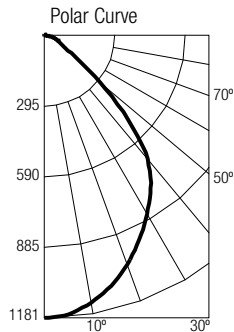

Illuminance at a Distance

Distance from Luminaire	FC at Nadir	Beam Diameter
6'	32.8fc	11'-12"
9'	14.6fc	16'-7"
12'	8.2fc	22'-1"
15'	5.2fc	27'-8"
18'	3.6fc	33'-2"

Zonal Lumen Summary

Zone	Lumens	% Luminaire
0-30	848	41.8
0-40	1332	65.6
0-60	1873	92.3
0-90	2015	99.3
90-180	15	0.7
0-180	2030	100

Candela Table

Vertical Angles	Candela
0	1180
5	1169
15	1083
25	941
35	779
45	503

Lumen Output Multipliers

Color Temperature: 2700K (0.84), 3000K (0.93), 3500K (0.95), 4000K (1.00)
Lumen Package: L09 (0.46), L15 (0.62), L25 (1.00)