

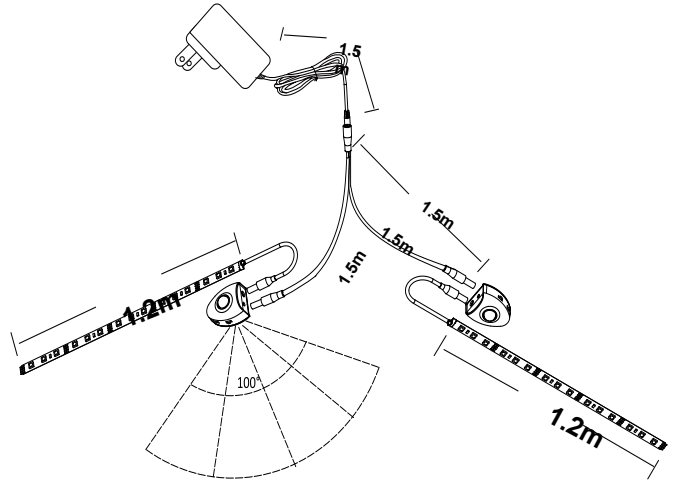

# MORRIS CAT#: 75301

## Insta-Flex Motion Sensing Tape Light

### 12V, 3W, 3000K



#### Features:

- For Institutional applications such as Nursing Homes; Commercial and Residential applications such as Under Beds, in Bathrooms, Undercabinet Lighting, Stairways and Closet

- AC Adaptor, Motion Sensor and Wire Clips Included

Adjustable Time Delay: 30 Sec, 130 Sec, 380 Sec

- 3M adhesive backing for easy installation
- 30,000+Hr LED Life Expectancy



- Strip Length: 4FT
- 2 Year Limited Warranty
- Environment: Suitable for Dry Locations
- Dimmable down to 10%
- Sensing Range: Out to 16'

Part#	Input/ Wattage	Volts	Lumens	CCT	CRI	Dimming	Light Pattern	Lumens/ FT	
75302	3W	12V	200	3000K	N/A	Down to 10%	Indoor	51	

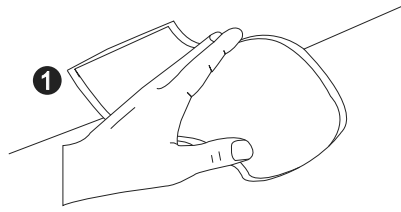

### 1 Clean Surface

Before installation, please completely clean and wipe the surface which need to be installed.  
See Figure 1



#### Option

it can be cut according to the length which you need

### 2 Connect components

Open and spread the LED strip, connect to the sensor and adapter,  
See Figure 2

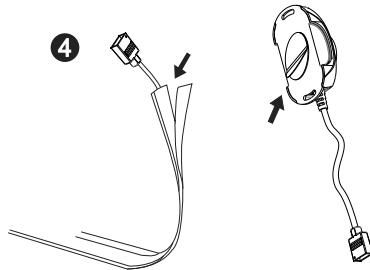

### 4 Installation under the bed

Place the connected components under the bed. To ensure that the adapter is plugged into a power socket, otherwise, add an extra power socket. Before installing the sensor and strips, please tear up 3M tape adhesive protection layer. see figure 4

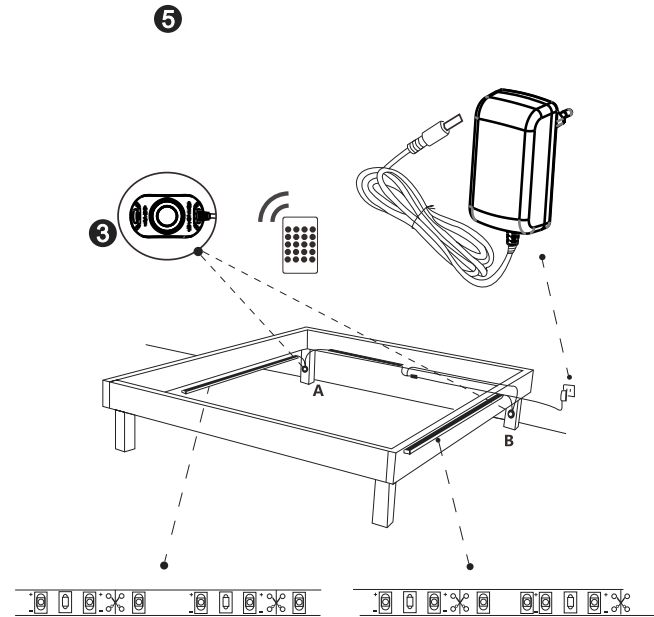

### 3 Choose the Sensor installation position

Choose a best position where the Sensor will be installed can directly feel body motion movement or the ambient light . advice A or B position , see figure 3

### 5 Power supply and test

please plug the adapter into the socket , see figure 5 . and then test it with the controller.

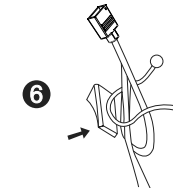

### 6 Installation suggestions

After finishing the installation , please use the right clips to fix the connection wires. see figure 6



Applications



# Installation display

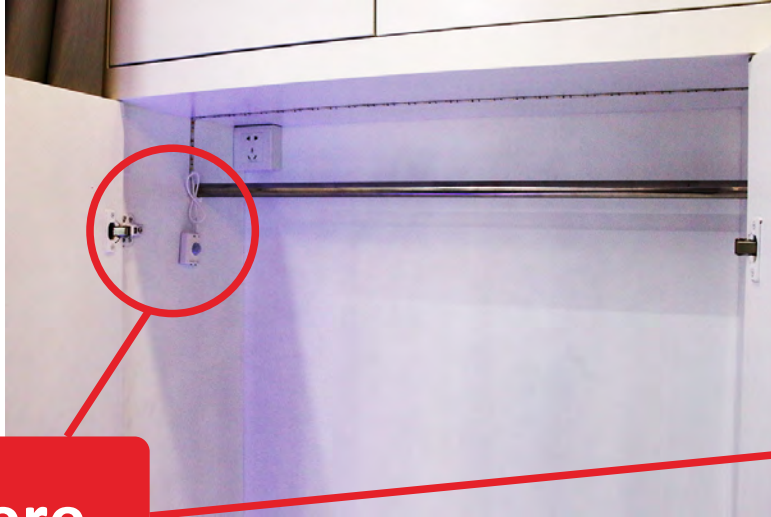

**Here**



# Applications



Suitable for single bed  
and double bed



For Kids