

## EMERGENCY BATTERY BACKUP

for Litetronics standard fixtures and retrofits

### DESCRIPTION

This battery backup unit delivers emergency power to a wide range of Litetronics standard LED panels, troffers, strips and retrofits. In the event of a power outage, it supplies the connected fixture with 90-minutes of light, enabling sufficient visibility for occupants to safely exit the space.

Designed with versatility in mind, this unit offers two options for mounting. When used with our range of grid ceiling solutions, the indicator module can be recessed in an adjacent panel. When used with drywall or open ceiling applications, our second option can be directly attached to the side of the fixture via adhesive. In both options, the indicator modules include lights that communicate the current status of the unit.

### FEATURES

- Provides 90 minutes of emergency light during power loss
- Monthly/annual self-testing
- Manual testing via remote control (optional)
- Indicator module mounting compatibility with grid ceiling, drywall, or open ceiling applications
- ETL approved for damp locations
- 50,000-hour rated life
- 5-year warranty
- 18" of flexible conduit included

### APPLICATIONS

- Emergency battery backup

### DIMENSIONS

- Driver: 15.88" x 1.77" x 0.965"
- Conduit: 18"



### SPECIFICATIONS

- Average rated life: 50,000 hours
- Warranty: 5 years
- Operating temperature: 32°F to 122°F
- Output power: 10 Watts
- Input voltage: 120-277V
- Input frequency: 50/60 Hz
- Operation time: 90 minutes
- Recharge time: 24 hours
- Weight: 1.76 lbs.
- Location rating: Damp
- ETL listed: Yes
- RoHS compliant: Yes

### CERTIFICATIONS



## ORDERING

### EB10 UNIT

ORDERING CODE	DESCRIPTION	WATTS	VOLTS
EB10	10W Emergency Battery Backup for standard fixtures	10	120-277



### INDICATOR MODULES

MODEL #	DESCRIPTION	USAGE
EBCM	Ceiling-mounted Indicator Module	This unit is used in grid ceiling applications. It connects to the EB10 and is recess mounted in an adjacent panel where it displays the unit's current status of operation.
EBAM	Adhesive-mounted Indicator Module	This unit is used in drywall/open ceiling applications. It connects to the EB10 and is mounted via adhesive to the side of the fixture, where it displays the unit's current status of operation.



### TEST REMOTE

MODEL #	DESCRIPTION	USAGE
TR01	Test remote for integrated EBB	Test and demo EBB functionality. One remote will control all EBB equipped units.



## OPERATION

- Fixtures will operate normally when power is available. When an outage occurs, the fixture will switch to battery backup, delivering power to the fixture for up to 90 minutes.
- If the EB10 battery runs out, the fixture will turn off until power is restored. Once restored, the EB10 battery will begin charging.
- Each indicator module option will display the current status of the unit; a green light indicates a full charge and a red light indicates the unit is currently charging.
- The EB10 includes automatic monthly and annual self-testing functionality. If a problem is detected, a yellow light will appear.
- Testing can also be done via remote control. Press the TEST button on the remote and the fixture will enter into emergency operation for three seconds, then resume normal operation.

## COMPATIBILITY LIST

The EB10 is compatible with the following Litetronics fixtures and retrofits.

LED LIGHT PANEL RETROFIT	LED VOLUMETRIC RETROFIT	LED MAGNETIC RETROFIT	LED STRIP FIXTURE
PRT1XX	VRT1XX	RFM3T2XXA	SFS2
PRT2XX	VRT2XX	RFM2T4XXA	SFS4
PRT4XX	VRT4XX	RFM3T4XXB	SFS8
PRT4XXW	VRT2XXW, VRT4XXW	RFM262T1XX	SF40S4XX
LED LIGHT PANEL	LED VOLUMETRIC TROFFER	RFM131T1XX	SF60S8XX
PT1XX	VLT1XX	RFM2T4XXEW	LED STAIRWELL FIXTURE
PT2XX	VLT2XX	RFM3T4XXDW	SWFS4
PT4XX	VLT4XX	LED GARAGE LIGHT	LED WRAP FIXTURE
		GL39URXXDLP	WFS4
		GL59URXXDLP	

## INDICATOR MODULE MOUNTING OPTIONS

---

### CEILING MOUNTED

In grid ceiling applications, the EB10 is mounted close to the driver and the indicator module is recessed in an adjacent panel where it will display the unit's current status of operation.

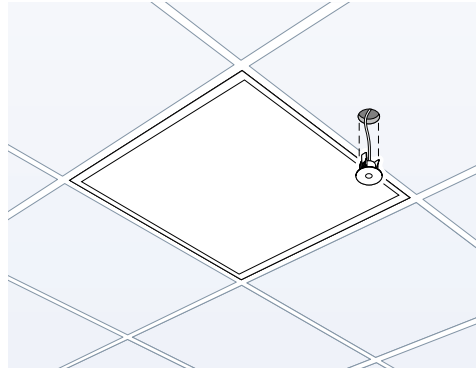
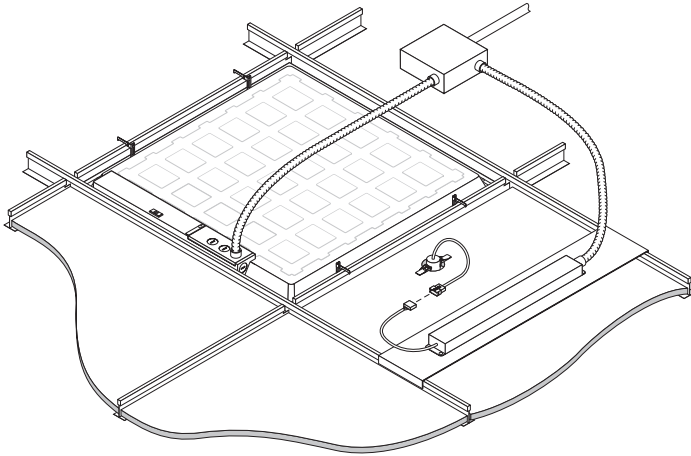

### ADHESIVE MOUNTED

In drywall or open ceiling applications, the EB10 is mounted close to the driver and the indicator module is attached via adhesive to the side of the fixture, where it will display the unit's current status of operation.

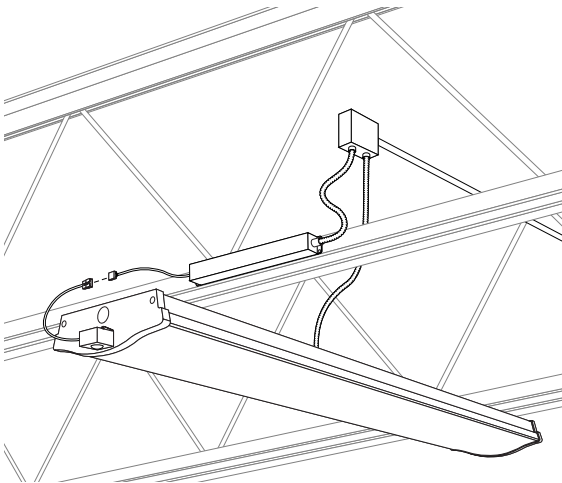

## HAVE QUESTIONS?

Our Customer Service team can help. Call us at 800-860-3392 or send an email to [customerservice@litetronics.com](mailto:customerservice@litetronics.com)