



# 4FT LED Wrap Light Build-in Battery Backup

54676341

Part # WR-4-40-940-MV-D-EM

## SPECIFICATIONS

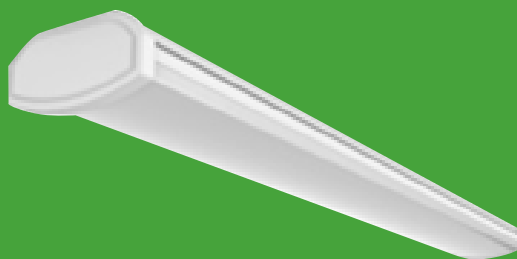

The ETi 4' LED Wrap light offers exceptional performance as a high quality replacement for traditional fluorescent light sources. Using only 45 watts of power to deliver 3600 lumens and lasting more than 5 times longer than fluorescent alternatives, this wrap light reduces energy and maintenance costs.

Designed to be used anywhere a traditional fluorescent fixture is used. Typically used in work shops, garages and utility rooms. Other common applications in commercial, office, retail, restaurants, schools, hospitals and hotel/motel locations.

### KEY FEATURES & BENEFITS

- 45 W
- 3600 LM
- 4000K
- 120-277V
- CRI ≥90
- Dimmable
- Damp Locations
- 50,000 hours rated life
- 5 years Warranty
- Operating Temperature: -4°F~95°F

### FIXTURE DIMENSIONS

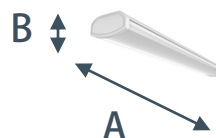

Part# WR-4-40-940-MV-D-EM  
Dimension A= 48"  
Dimension B= 3"

This device complies with part 15 of the FCC Rules. Operation is subject to the following two conditions: (1) This device may not cause harmful interference, and (2) this device must accept any interference received, including interference that may cause undesired operation. For FCC Part 15 user information, Please see [www.etissl.us/fcc15b](http://www.etissl.us/fcc15b)

[www.etissl.com](http://www.etissl.com)  
855-384-7754



# 4FT LED Wrap Light

## Build-in Battery Backup

54676341

Part # WR-4-40-940-MV-D-EM

### SPECIFICATION DATA

Item Number	Description	Watts	Input Voltage (VAC)	Average Rated Life <sup>1</sup>	Typical Lumens <sup>2</sup>	CCT <sup>3</sup>	CRI <sup>4</sup>	Power Factor	R9	Beam Angle	Operating Frequency
54676341	LED Wrap Light	45	120-277	50,000 hours	3600	4000	≥90	>0.9	51	112°	50/60Hz
<sup>1</sup> Hours lifetime with 70% lumen maintenance											
<sup>2</sup> Thermally stable typical lumens											
<sup>3</sup> in compliance with ANSI C78.377 2008											
<sup>4</sup> Color rendering index/Ra											

### SHIPPING INFORMATION

Item Number	Item UPC	Item Dimensions (L x W x H)	Item Weight (lbs)	Inner Pack Qty	Inner Carton Bar Code	Inner Carton Dimensions (L x W x H)	Inner Pack Weight (lbs)	Master Pack QTY	Master Carton Bar Code	Master Dimensions (H x L x W)	Master Pack Weight (lbs)
54676341	849489 009933	48" x 6" x 3"	8.07	NA	NA	NA	NA	2	5084948 9009938	52.28" x 8.27" x 7.6"	20.73



The Americas Headquarters  
 720 Corporate Woods Parkway  
 Vernon Hills, IL 60061  
 855-384-7754  
[www.etissl.com](http://www.etissl.com)

