



## General Illumination Pendant Stem Cylinder

6"

### Feature Set

- Batwing distribution with feathered edges provides even illumination on horizontal and vertical surfaces
- Bounding Ray™ optical design
- 45° cutoff to source and source image
- Fully serviceable lensed LED light engine
- 70% lumen maintenance at 60,000 hours
- 2.5 MacAdam Ellipse; 85 CRI typical, 90+ CRI optional
- Fixtures are damp location standard; Wet location (WL) optional, requires covered ceiling
- 20 standard colors in textured and gloss finish; custom or RAL colors also available
- Multiple recessed or surface j-box mounting configurations available
- Field cuttable 5/8" stems with concealed couplers.
- ENERGY STAR® Certified product
- UGR of zero for fixtures aimed at nadir with a cut-off equal to or less than 60deg per CIE 117-1995 Discomfort Glare in Interior Lighting. [UGR FAQ](#)

### Distribution

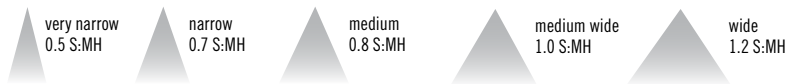

### Superior Performance

Nominal Lumens	250	500	750	1000	1500	2000	2500	3000	3500	4000	4500	5000	6000	8000
Delivered Lumens	297	519	776	994	1471	2006	2537	3077	3542	4027	4533	5256	6371	8247
Wattage	3.4	6.2	8.2	9.6	14.7	19.7	24.7	29.5	33.8	39.0	47.3	48.7	57.6	74.9
Lumens per Watt	87.4	83.7	94.6	103.5	100.1	101.8	102.7	104.3	104.8	103.3	95.8	107.9	110.6	110.1



### Coordinated Apertures | Multiple Layers of Light



General Illumination Layer | EVO



High Center Beam Layer | Incito



EVO + Incito — Multiple Layers of Light

### Core



Downlight



Adjustable



Open Wallwash



Lensed Wallwash



Cylinder



Pinhole



Bevel



Hyperbolic

### Healthcare



MRI



Surgical Suite



Patient Room

### Special Applications



Dynamic



Food Service



Vandal/Tamper



Clean Room



Shower



Steam Room

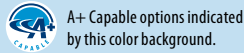

Luminaire Type:

Catalog Number:

EXAMPLE: EV06PC 35/15 AR MWD LSS MVOLT EZ1 JBXCC PCAN S12 DWHG

Series	Color Temperature	Lumens	Reflector Color	Reflector Finish	Distribution	Voltage
EV06PC EVO 6in Pendant Stem Round Cylinder Open Downlight	27/ 2700 K	02 250 lumens	AR Clear	LSS Semi-specular	VND Very narrow (0.5 s/mh)	MVOLT 120V - 277V
	30/ 3000 K	05 500 lumens	PR Pewter	LD Matte diffuse	ND Narrow (0.7 s/mh)	120 120V
	35/ 3500 K	07 750 lumens	WTR Wheat	LS Specular	MD Medium (0.9 s/mh)	277 277V
	40/ 4000 K	10 1000 lumens	GR Gold		MWD Medium wide (1.0 s/mh)	347 <sup>2</sup> 347V
	50/ 5000 K	15 1500 lumens	WR <sup>1</sup> White painted		WD Wide (1.2 s/mh)	
		20 2000 lumens	BR <sup>1</sup> Black			
		25 2500 lumens	WRAMF <sup>1</sup> White Anti-microbial			
		30 3000 lumens	BZR <sup>1</sup> Dark Bronze painted			
		35 3500 lumens	TRALTBD <sup>1</sup> Trim RAL # TBD (TBD for pricing only)			
		40 4000 lumens	TCPC <sup>1</sup> Trim Custom Paint Color TBD (TBD for pricing only)			
		45 4500 lumens				
		50 5000 lumens				
		60 6000 lumens				
		80 8000 lumens				

Driver <sup>3</sup>	Mounting	Canopy Type	Stem Length <sup>10</sup>
GZ10 0-10V driver dims to 10%	JBX Integral driver, Recessed or Surface J-box	PCAN 5° Stem canopy with "hang straight" swivel	S2 2 foot 5/8" stem
GZ1 0-10V driver dims to 1%	JBXCC Integral driver, Surface J-box with Conduit Covers	PCAN45° 45° Stem canopy with "hang straight" swivel	S4 4 foot 5/8" stem
EZ10 eldoLED 0-10V ECOdrive. Linear dimming to 10% min.	SGB <sup>7</sup> Surface gear box. Recessed or surface J-box		S6 6 foot 5/8" stem
EZ1 eldoLED 0-10V ECOdrive. Linear dimming to 1% min.	SGBCC <sup>7</sup> Surface gear box (for driver at ceiling), surface J-box with Conduit Covers.		S8 8 foot 5/8" stem
EZB eldoLED 0-10V SOLOdrive. Logarithmic dimming to <1%.	RGH <sup>8</sup> Recessed Gear Housing		S10 10 foot 5/8" stem
EDAB <sup>4</sup> eldoLED SOLOdrive DALI. Logarithmic dimming to <1%.			S12 12 foot 5/8" stem
EDXB <sup>4,5,6</sup> eldoLED POWERdrive DMX with RDM (remote device management). Square Law dimming to <1%. Min: 1000LM; Max: 8000LM. Not available with Emergency Options.			S16 16 foot 5/8" stem
ECOD <sup>4</sup> Lutron® EcoSystem® digital Hi-Lume 1% soft-on, fade to black. Max: 8000LM except 4500LM.			S20 20 foot 5/8" stem
ELV <sup>4</sup> Electronic line voltage / Forward phase / Triac dimming, 120V Only.			

Emergency Option	Control Interface <sup>11</sup>	Options	Architectural Colors - Powder Paint <sup>17</sup>
(blank) No emergency options	(blank) No controls	SF Single fuse. Specify 120V or 277V.	DDB Gloss Dark Bronze
E6W 6W integral Constant Power, CA Title 20 compliant emergency battery pack with integral test switch. Only available with GZ10, GZ1 and ELV Drivers. Only for use with 500-4500 lumen options.	NLT nLight® dimming pack. Specify 120V or 277V.	90CRI High CRI (90+)	DBL Matte Black
E7WCP IOTA® 7W emergency battery (sidecar). Only for use with 750-8000 lumen options.	NLTER <sup>12</sup> nLight® dimming pack for fixtures on emergency circuit. Specify 120V or 277V.	N80 <sup>13</sup> nLight Lumen Compensation	DWH Gloss White
E10WCP IOTA® 10W Constant Power, CA Title 20 compliant emergency battery pack with integral test switch. Only for use with 1000-8000 lumen options. (sidecar or RGH)	NLTAIR2 nLight® AIR dimming pack. Specify 120V or 277V.	HAO <sup>14</sup> HAO High Ambient Option (40°C)	DMB Matte Medium Bronze
E10WCPR IOTA® 10W Constant Power, CA Title 20 compliant emergency battery pack with remote test switch (requires RGH)	NLTAIRER2 <sup>12</sup> nLight® AIR dimming pack for fixtures on emergency circuit. Specify 120V or 277V.	WL <sup>15</sup> Wet Location	DNA Gloss Natural Aluminum
E15WCP IOTA® 15W emergency battery. Only for use with 1500-8000 lumen options. (sidecar)		CP <sup>16</sup> Chicago Plenum. Specify 120V or 277V (requires RGH)	DSS Gloss Sandstone
GTD IOTA® Generator Transfer Device. Specify 120V or 277V (requires RGH)			DGC Gloss Charcoal Grey
			DTG Gloss Tennis Green
			DBR Gloss Bright Red
			DSB Gloss Steel Blue
			DBLT Textured Dark Bronze
			DBLB Textured Black
			DWHG Textured White
			DBNH Textured Bronze
			DNAT Textured Natural Aluminum
			DSST Textured Sandstone
			DSPD Textured Dark Grey
			DSPE Textured Green
			DSPH Textured Light Red
			DWHAMF Gloss White with Anti-microbial finish
			RALTBD Cylinder RAL # TBD (TBD for pricing only)
			CPC Cylinder Custom Paint Color TBD (TBD for pricing only)

**ACCESSORIES — order as separate catalog numbers (shipped separately)**

<b>GCOLORS KIT</b>	Architectural colors chip kit, consisting of powder-coat and plated finishes
<b>CYLJBXADPT 4SQ2OCT</b> ____	4in Square J-box to 4in Octagonal J-box adaptor. Replace ____ with Architectural Color or PRM for primed ready for field painting
<b>CYLSTBL KIT</b>	Stabilization Kit for securing pendant stem fixtures

**ORDERING NOTES**

- Not Available with Finishes.
- Integral 347V drivers available with GZ10 and GZ1 driver options only - 3000LM max. All other drivers (and GZ1 & GZ10 above 3000LM) will come with a step-down transformer - factory installed with RGH mounting, and field installed with JBX and JBXCC mounting (remote mount location and access to device required). Not available with Emergency Options.
- Refer to [Tech 240](#) for compatible dimmers.
- Not Available with Control Interfaces.
- Requires SGB or SGBCC mounting option.
- Includes terminator resistor.
- Only available with DMX driver (EDXB).
- Not available with E6W, E7W or E15WCP Emergency Options.
- Not available with SGB or SGBCC: those mountings require a flat ceiling.
- Stem section adjacent to cylinder can be cut in field to achieve non-uniform lengths (i.e. for a field cut 3' length, order 4' stem).
- Factory installed with RGH option otherwise field installed. Access required to location of remote mounted device.
- ER for use as UL924 Emergency Operation via power sense lead. Will require an emergency hot feed and normal hot feed. EM for use as UL924 Emergency Operation
- Fixture begins at 80% light level. Must be specified with NLT or NLTER. Only available with EZ10 and EZ1Yrivers.
- Only available up to 3500 lumens. Not available with ECOS2 or WL or sidecar Emergency Options.
- Not available with JBXCC, SGB, or SGBCC. Max: 3500LM.
- CP not valid with NLTAIR2, NLTAIRER2 or Emergency Options.
- For details on RAL and Custom colors please see [Architectural colors](#).

## Optical Assembly

Fully serviceable and upgradeable lensed LED light engine suitable for field maintenance or service from below the ceiling.

Optical design is a Bounding Ray™ design with 45° cutoff to source and source image. Top down flash characteristic for superior glare control.

## Electrical

The luminaire shall operate from a 50 or 60 Hz  $\pm 3$  Hz AC line over a voltage ranging from 120 VAC to 277 VAC. Support 347V via remote-mounted stepdown transformer. The fluctuations of line voltage shall have no visible effect on the luminous output.

The luminaire shall have a power factor of 90% or greater at all standard operating voltages and full luminaire output.

Sound Rated A+. Driver shall be >80% efficient at full load across all input voltages.

Input wires shall be 18AWG, 300V minimum solid copper.

## Controls

Luminaire shall be equipped with interface for nLight wired or nLight AIR networks with integral power supply as per specification.

## Emergency

Luminaires supplied with a battery pack comply with NFPA 101 (Life Safety code) and deliver constant light output throughout the 90 minutes of code required emergency operation period when there is a normal AC power loss.

Luminaires equipped with a generator transfer device work in conjunction with an auxiliary generator or a central inverter system to power fixtures for safe egress lighting.

## Dimming

The luminaire shall be capable of continuous dimming without perceivable stroboscopic flicker as measured by flicker index (ANSI/IES RP-16-10) over a range of 100 – 10%, 100 – 1.0% or 100 – 0.1% of rated lumen output with a smooth shut off function to step to 0%.

eldoLED LED drivers shall conform to IEEE P1789 standards. Alternatively, manufacturers must demonstrate conformance with product literature and testing which demonstrates this performance. Systems that do not meet IEEE P1789 will not be considered.

Driver is inaudible in 24dB environment, and stable when input voltage conditions fluctuate over what is typically experienced in a commercial environment.

## Construction

Heaving-gauge aluminum construction. Extruded cylinder body with flangeless reflector allows flow-through passive thermal management. Canopy matches cylinder in finish and diameter.

Pendant stem mount for installation to 4" recessed or surface octagonal junction box with integral driver.

Recessed gear box available for driver above ceiling, nLight, CP, GTD or battery pack options.

Surface gear box available for driver at ceiling installation.

Optional field configurable conduit covers available. Conduit covers match cylinder in finish and diameter.

**WARNING: All pendant fixtures exposed to wind require tethering – see page 6.**

## Listings

Fixtures are CSA Certified to meet US and Canadian Standards: All fixtures manufactured in strict accordance with the appropriate and current requirements of the "Standards for Safety" to UL, damp location standard; wet location (WL) optional, requires covered ceiling.

Luminaire configurations are Energy Star certified through testing in EPA-recognized laboratories, with the results reviewed by an independent, accredited certification organization. Visit [www.energystar.gov](http://www.energystar.gov) for specific configurations listed.

## Photometrics

LEDs tested to LM-80 standards. Measured by IESNA Standard LM-79-08 in an accredited lab. Lumen output shall not decrease by more than 30% over the minimum operational life of 60,000 hours.

Color appearance from luminaire to luminaire of the same type and in all configurations, shall be consistent both initially and at 60,000 hours and operate within a tolerance of <2.5 MacAdam ellipse as defined by the center of the quadrangles defined in ANSI C78.377-2015.

## BUY AMERICAN ACT

This product is assembled in the USA and meets the Buy America(n) government procurement requirements under FAR, DFARS and DOT regulations.

Please refer to [www.acuitybrands.com/buy-american](http://www.acuitybrands.com/buy-american) for additional information.

## Warranty

5-year limited warranty. This is the only warranty provided and no other statements in this specification sheet create any warranty of any kind. All other express and implied warranties are disclaimed. Complete warranty terms located at: [www.acuitybrands.com/support/warranty/terms-and-conditions](http://www.acuitybrands.com/support/warranty/terms-and-conditions)

## Note:

Actual performance may differ as a result of end user environment and application.

All values are design or typical values, measured under laboratory conditions at 25 °C.

## A+ Capable Luminaire

This item is an A+ capable luminaire, which has been designed and tested to provide consistent color appearance and out-of-the-box control compatibility with simple commissioning.

- All configurations of this luminaire meet the Acuity Brands' specification for chromatic consistency
- This luminaire is part of an A+ Certified solution for nLight® control networks when ordered with drivers marked by a shaded background\*
- This luminaire is part of an A+ Certified solution for nLight® control networks, providing advanced control functionality at the luminaire level, when selection includes driver and control options marked by a shaded background\*

To learn more about A+, visit [www.acuitybrands.com/aplus](http://www.acuitybrands.com/aplus).

\*See ordering tree for details

EVO - eldoLED Driver Default Dimming Curve

Nomenclature	Min Dimming	Driver Dim Curve	Control Dim Curve
EZ10	10%	Linear	Linear/Logarithmic
EZ1	1%	Linear	Linear/Logarithmic
EZB	<1%	Logarithmic	Linear
EDAB	<1%	Logarithmic*	Linear
EDXB	<1%	Square	Linear

\*Changeable through DALI controller

Control Provided  
(note: 347V/UVOLT versions provided with 347 option selected)

Nomenclature	Description	NLT	NLTER	NLTAIR2	NLTAIRER2
GZ10	0-10V driver dims to 10%	nPP16 D EFP	nPP16 D ER EFP	RPP20 D 24V G2	RPP20 D 24V ER G2
GZ1	0-10V driver dims to 1%	nPP16 D EFP	nPP16 D ER EFP	RPP20 D 24V G2	RPP20 D 24V ER G2
EZ10	eldoLED 0-10V ECOdrive	nPS 80 EZ	nPS 80 EZ ER	RPP20 D 24V G2	RPP20 D 24V ER G2
EZ1	eldoLED 0-10V ECOdrive	nPS 80 EZ	nPS 80 EZ ER	RPP20 D 24V G2	RPP20 D 24V ER G2
EZB	eldoLED 0-10V SOLOdrive	nPS 80 EZ	nPS 80 EZ ER	RPP20 D 24V G2	RPP20 D 24V ER G2

J-box Compatibility Matrix

Cylinder Configurations

		JBX	SGB	SGBCC	SGB w/EDXB Driver	SGBCC w/EDXB Driver	JBXCC
Recommended J-box (by others)	4" Octagonal 4x4x1.5 deep"	✓	✓	✓	✓	✓	✓
	4" Octagonal 4x4x2.125 deep	✓	✓	✗	✓	✗	✗
	4" Square 4x4x1.5 deep	*with adaptor plate accessory	*with adaptor plate accessory	✗	*with adaptor plate accessory	✗	✗

## Standard Architectural Color Options for Cylinder Bodies

 <b>DSS LITHONIA</b> P12 Sandstone	 <b>DSST TEXTURED</b> P90 Sandstone	 <b>DBR LITHONIA</b> P34 Bright Red	 <b>DSPH TEXTURED</b> P80 Light Red	 <b>DMB LITHONIA</b> P11 Medium Bronze	 <b>DBNH TEXTURED</b> P74 Bronze	 <b>DTG LITHONIA</b> P33 Tennis Green	 <b>DSPE TEXTURED</b> P78 Green
 <b>DSB LITHONIA</b> P49 Steel Blue	 <b>DNA LITHONIA</b> P07 Natural Aluminum	 <b>DNAT TEXTURED</b> P89 Natural Aluminum	 <b>DGC LITHONIA</b> P32 Charcoal Gray	 <b>DSPD TEXTURED</b> P77 Dark Grey	 <b>DDB LITHONIA</b> P50 Dark Bronze	 <b>DDBT TEXTURED</b> P88 Dark Bronze	 <b>DBL LITHONIA</b> P13 Black
 <b>DBLB TEXTURED</b> P75 Black	 <b>DWH LITHONIA</b> P21 White	 <b>DWHG TEXTURED</b> P86 White					

NOTE: These colors were carefully reproduced to give as true a depiction as possible of finished product color. Some colors, however, may vary slightly from actual appearance due to display/printing variations and limitations. Please order the GCOLORS KIT listed in the 'Accessories' section of the spec sheet for an accurate paint chip sample.

### Stabilization Kit (CYLSTBL KIT) Accessory

The Stabilization Kit offers additional support for applications where wind may be a factor and the pendant stem cylinder needs to be secured.

#### Cables

Three (3) 20 ft. 304 grade stainless steel aircraft cables with outer diameters of 1/16" are attached to anchoring mechanisms in the mounting surface at one end and the provided stem collar around the pendant stem at the other end.

Cables should be anchored 120° +/- 10° from each other radially and positioned at 45° or greater from the stem for optimal support of the fixture.

#### Clamps and Stem Collars

The stem collar consists of two (2) half stem collars made of 304 stainless steel. Both stem collar halves are attached around the pendant stem with 304 stainless steel socket head cap screws.

Six (6) cable clamps made of 304 stainless steel are used in the stabilization kit with two (2) clamps per cable attached to each anchoring point and the stem collar.

The cable tension can be adjusted from either end.

#### Wind Load

The Stabilization Kit is designed to withstand 90mph winds for 3 seconds comparable to ASCE 7-10, MRI 50-year (fixture EPA is 0.3 sq ft)

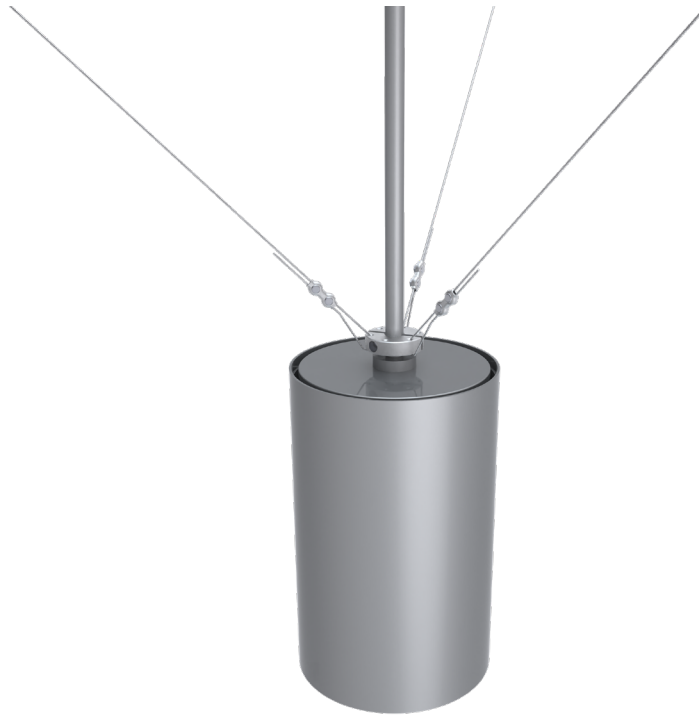



JBX Recessed J-Box

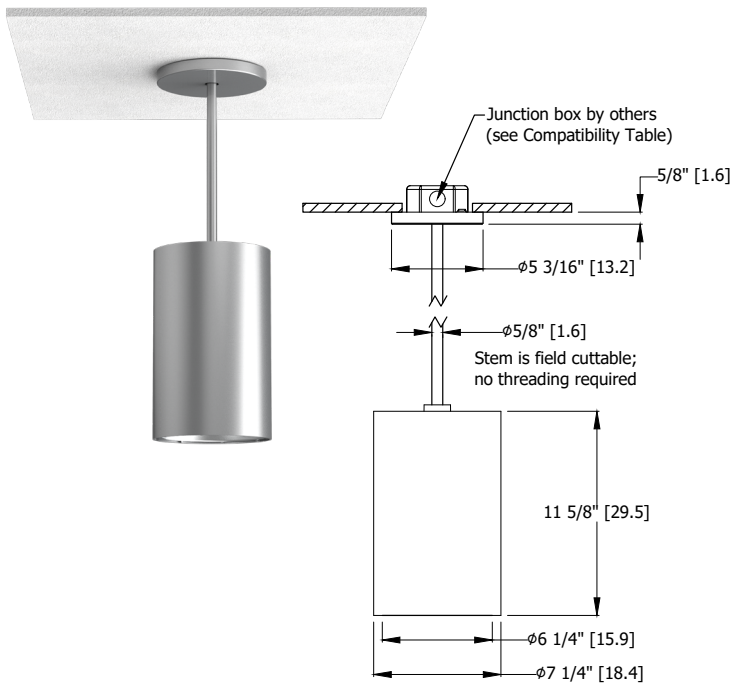

JBX Surface J-Box

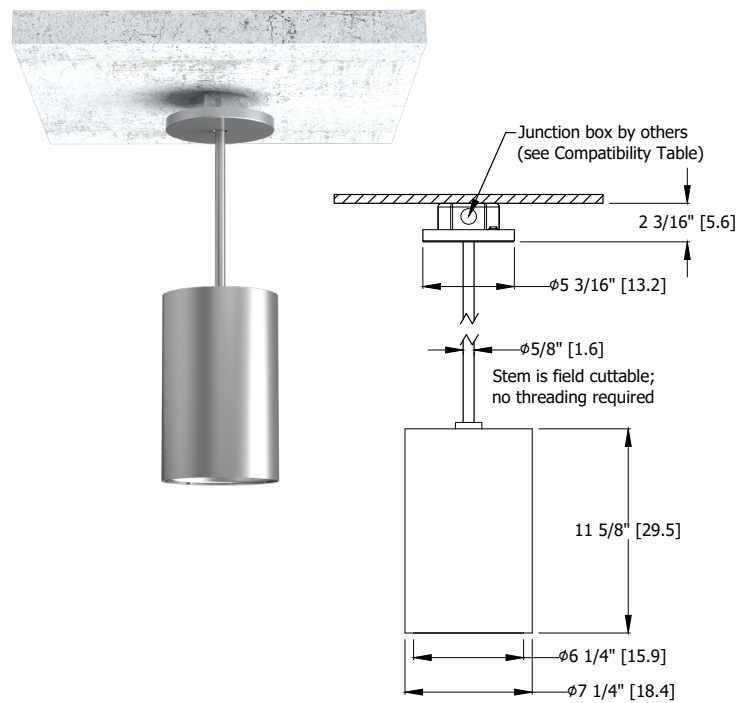

JBXCC Surface J-Box with Conduit Covers

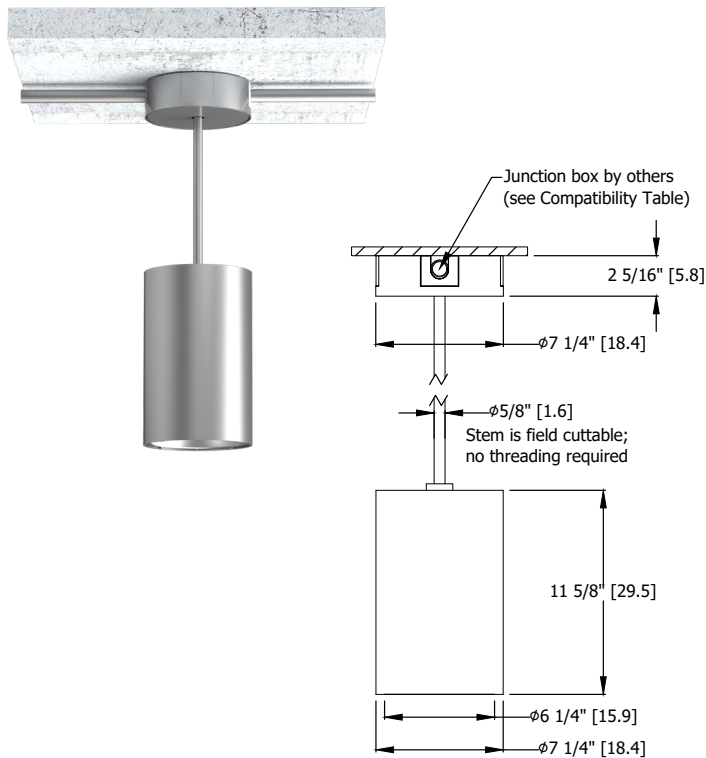

Stem\_PCAN vs PCAN45

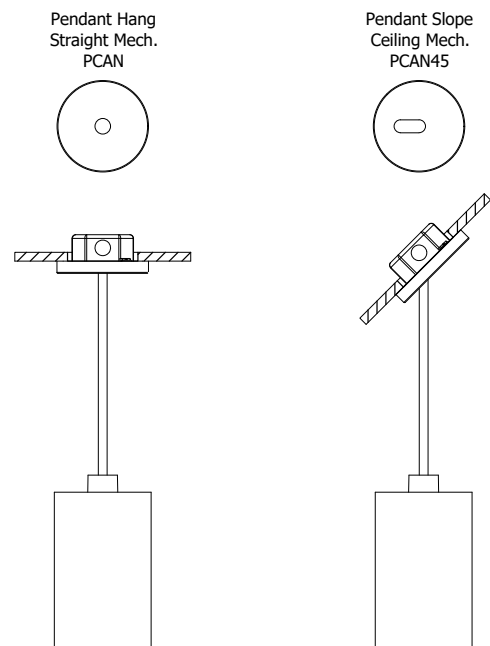

\*Dimensions in inches [centimeters]

### Stem Cutting Formulas for JBX

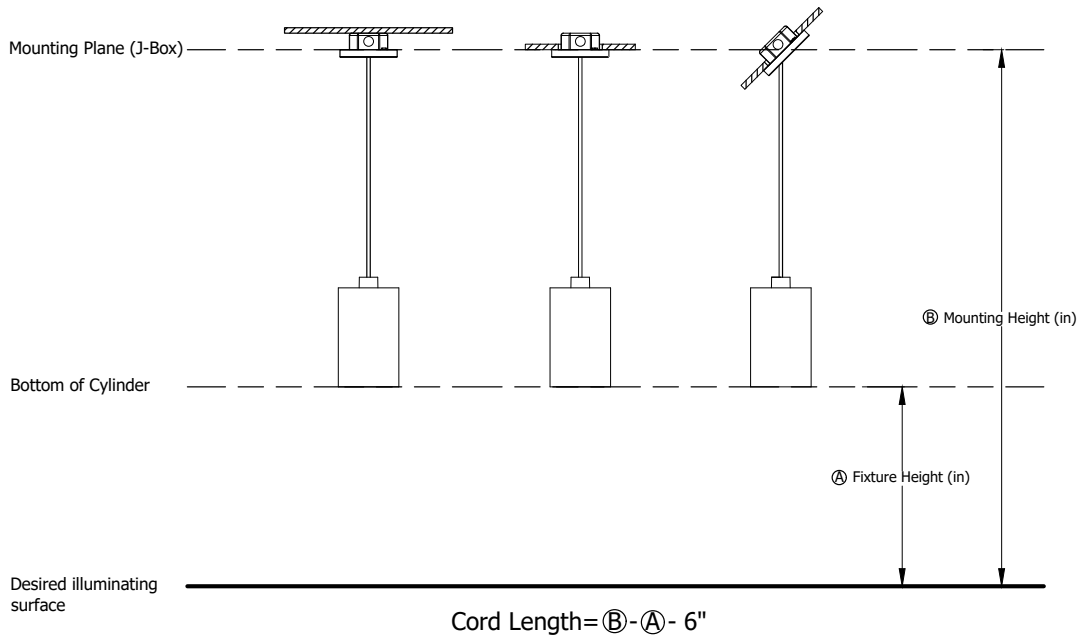

### Conduit Feed Examples and Keys

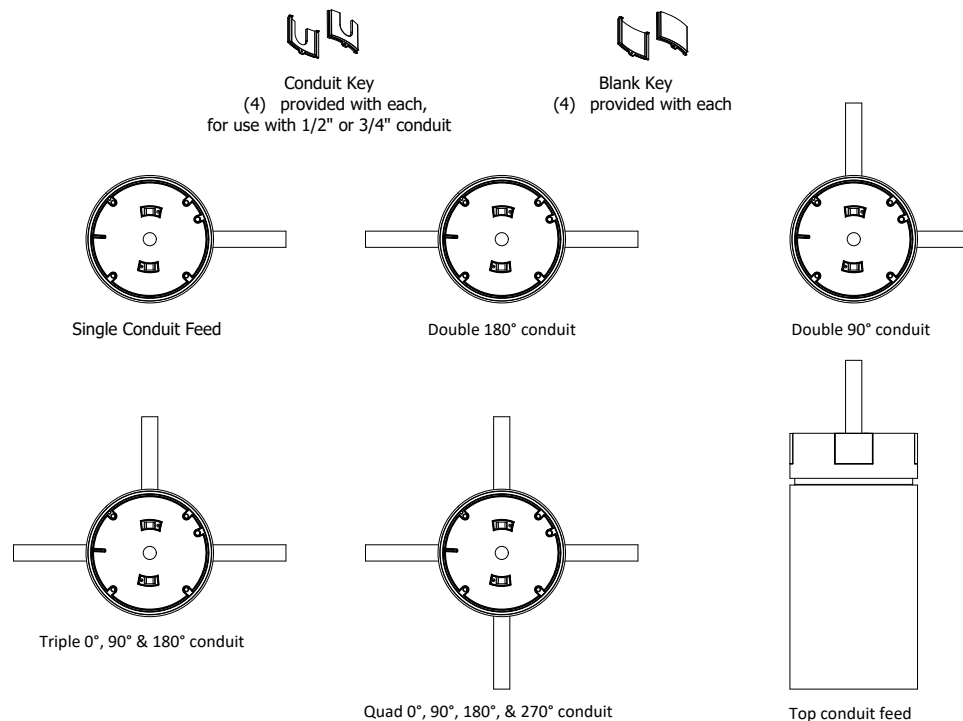

\*Dimensions in inches [centimeters]



**SGB Surface Gear Box for EDXB recessed J-box**

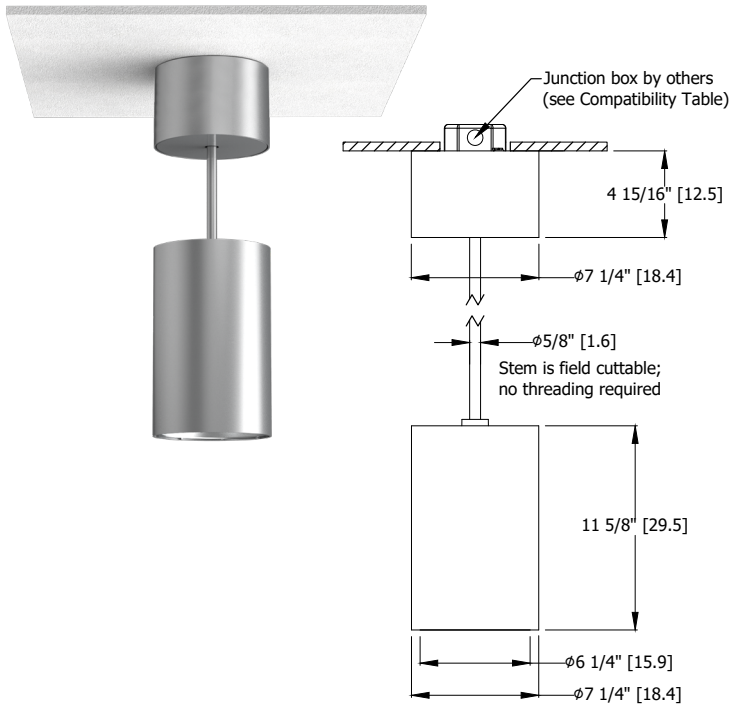

**SGB Surface Gear Box for EDXB surface J-box**

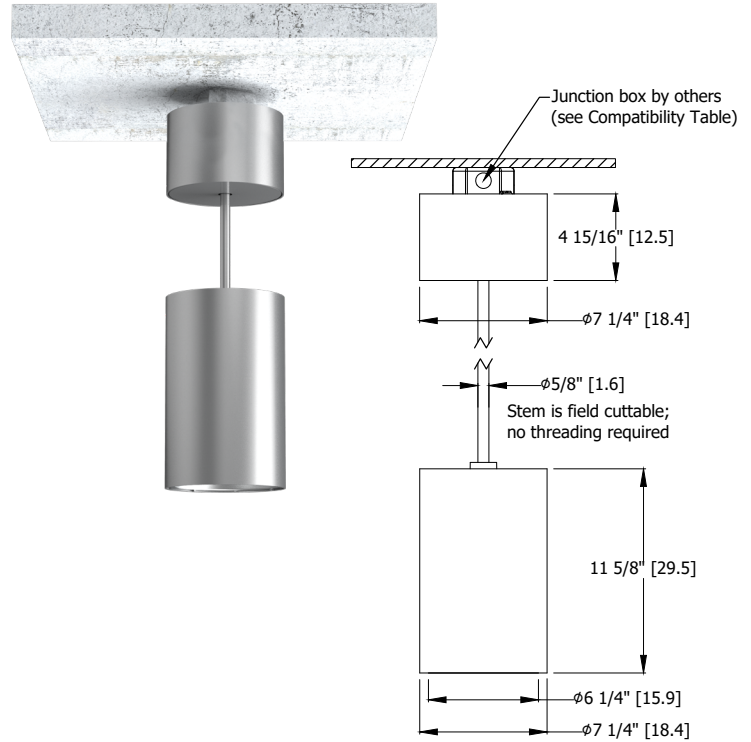

**SGBCC Surface Gear Box for EDXB with Conduit Covers**

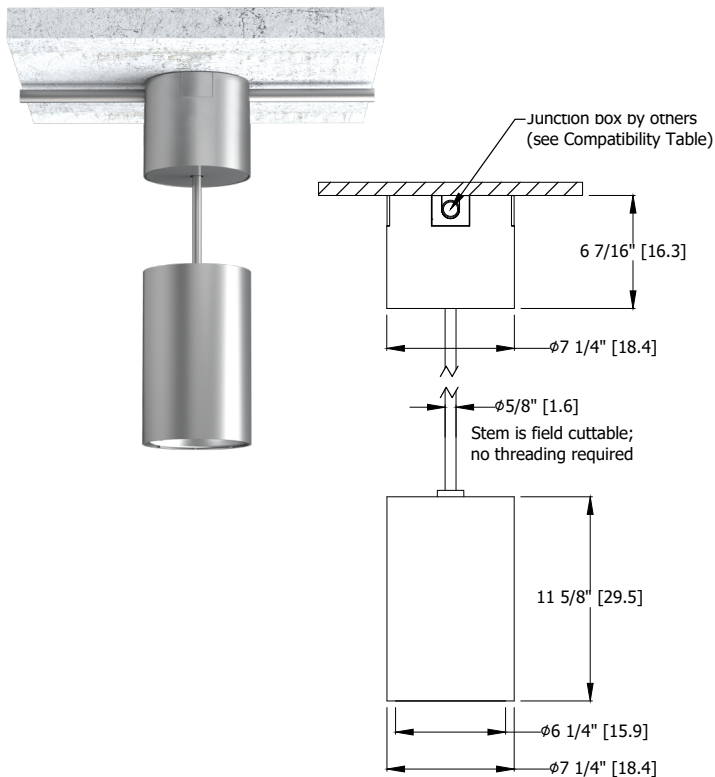

**Stem Connection Method**

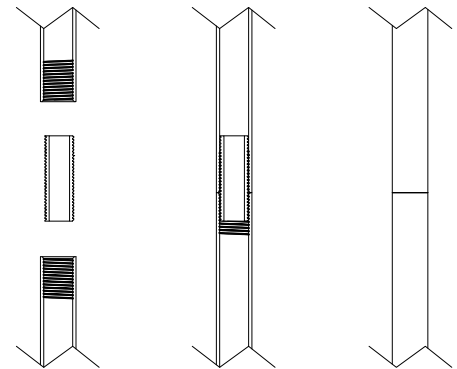

\*Dimensions in inches [centimeters]

### Stem Cutting Formulas for SGB

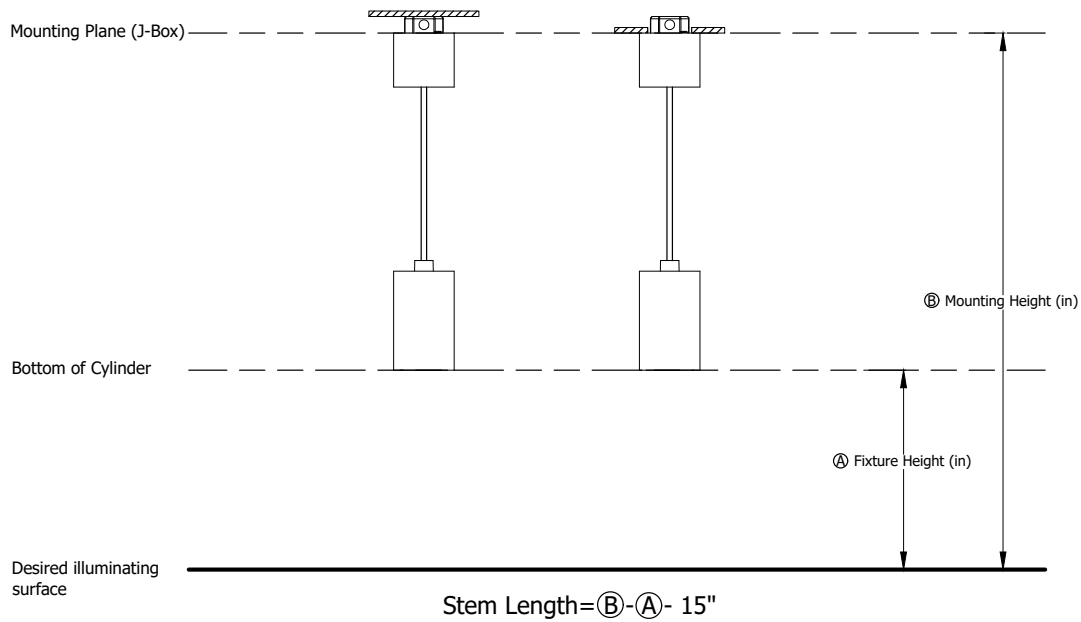

### Cylinder Adaptor Plate

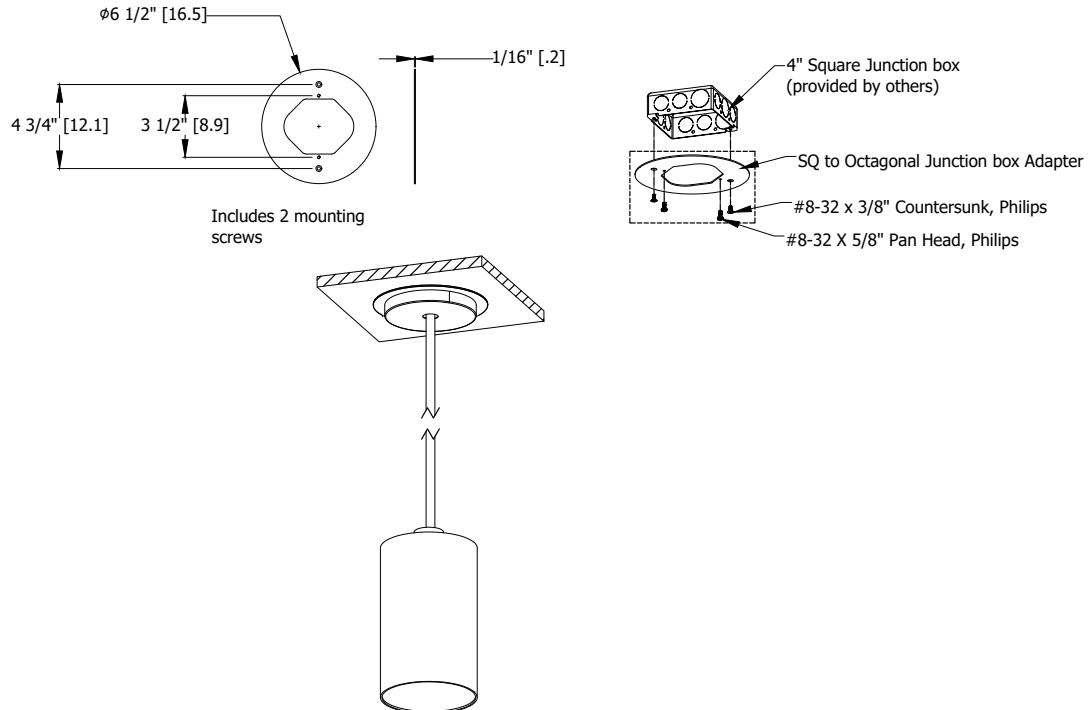

\*Dimensions in inches [centimeters]

### Junction Box Dimensions (by others)

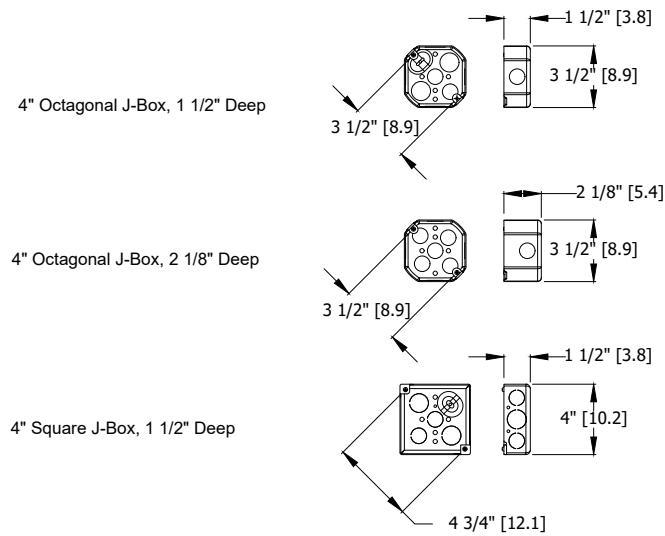

### 347V Stepdown Transformer

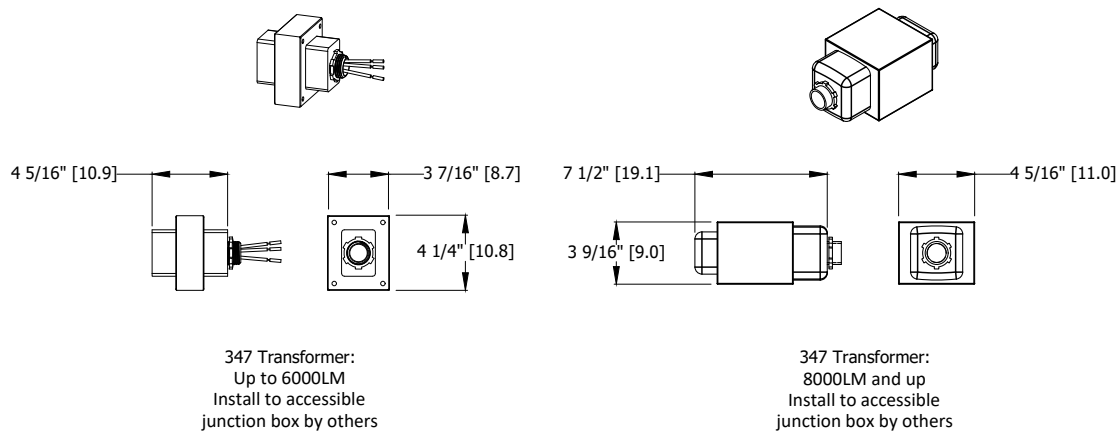

\*Dimensions in inches [centimeters]

**RGH 2500LM-5000LM and with EDXB up to 4500LM & ECOD up to 4000LM Standard**

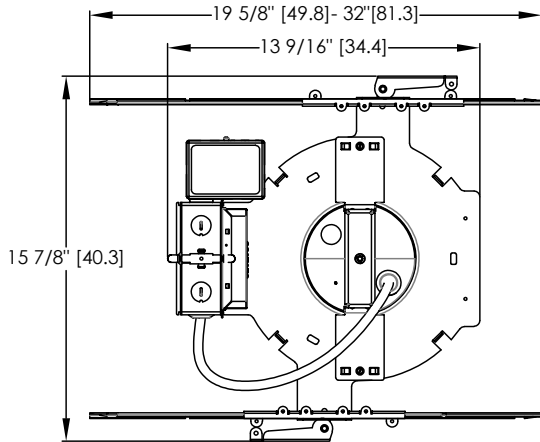

Ceiling thickness range: 1/2" [1.3] to 3" [7.6]  
Ceiling cutout: 5 1/16" [12.9]

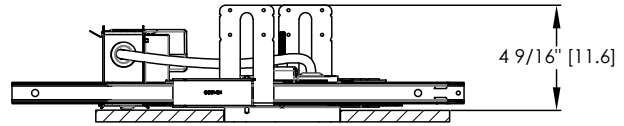

**RGH with Battery Backup (E10WCPR) 2500LM-5000LM and with EDXB up to 4500LM & ECOD up to 4000LM Standard**

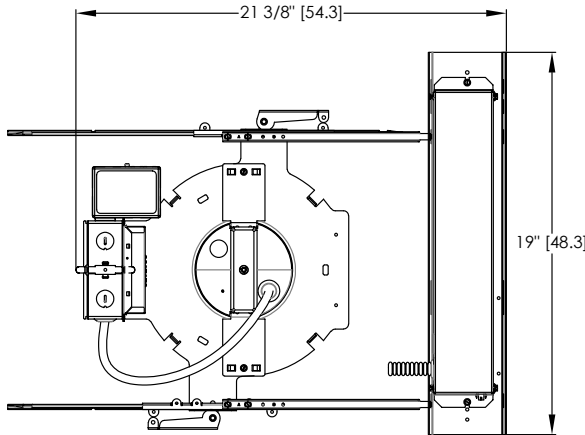

With Emergency Battery or GTD option  
Minimum plenum height for emergency batteries in non-accessible ceilings: 12 1/2" [31.8]  
Ceiling thickness range: 1/2" [1.3] to 3" [7.6]  
Ceiling cutout: 5 1/16" [12.9]

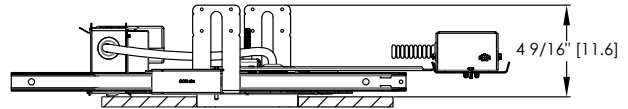

\*Dimensions in inches [centimeters]

RGH with CP 2500LM-5000LM and for use with EDXB up to 4500LM & ECOD up to 4000LM Standard

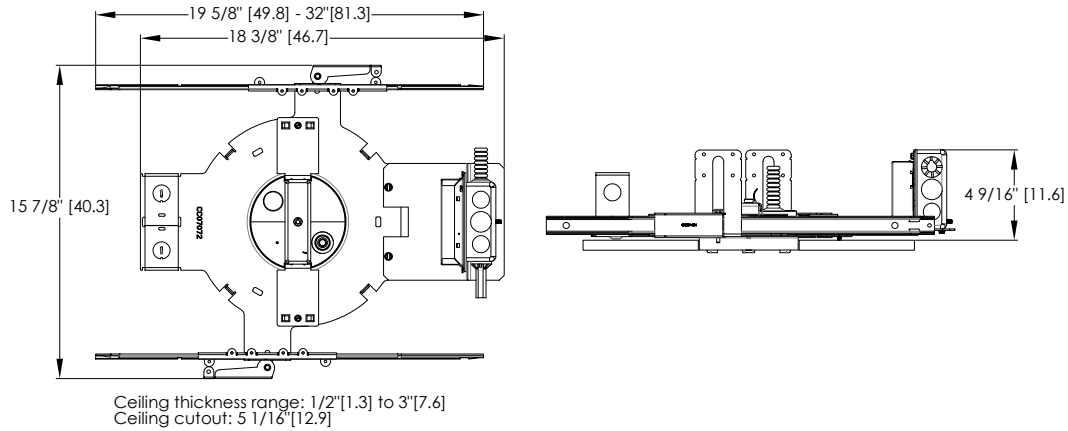

RGH with Chicago Plenum (CP) for use with nLight Enclosed

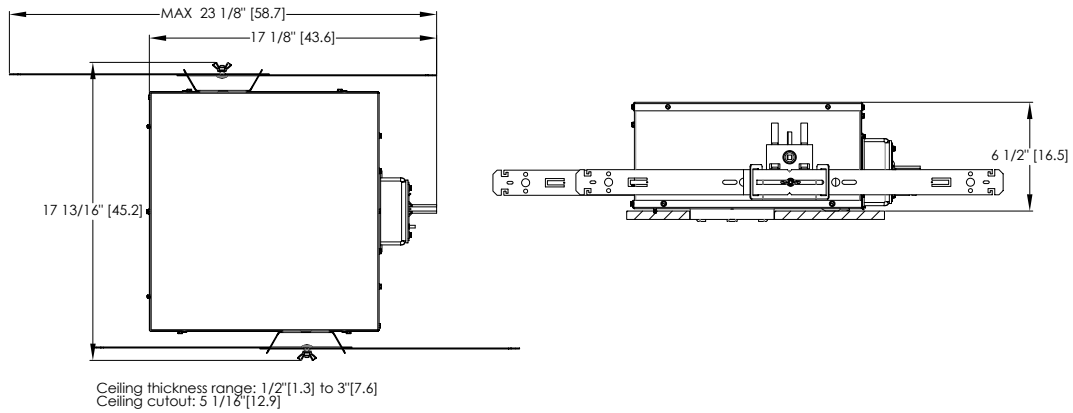

\*Dimensions in inches [centimeters]

**RGH Double Driver 5000LM+ EDXB & ECOD, 6000LM & 8000LM Standard**

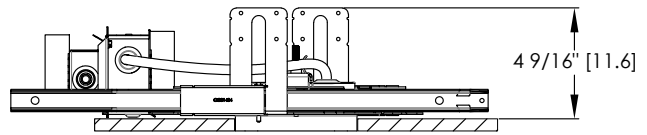
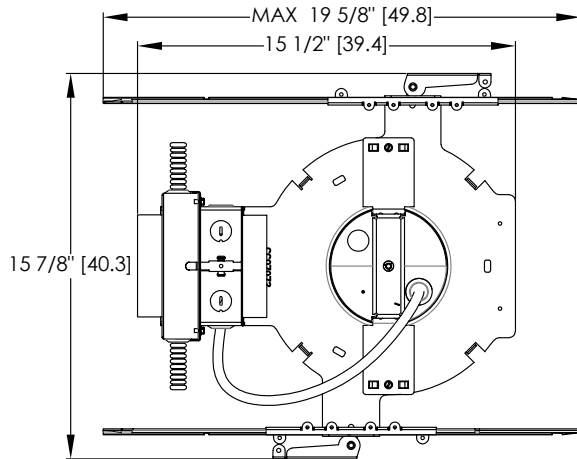

Ceiling thickness range: 1/2" [1.3] to 3" [7.6]  
Ceiling cutout: 5 1/16" [12.9]

**RGH Double Driver with Battery Backup (E10WCPR) for use with 5000LM+ EDXB & ECOD, 6000LM & 8000LM Standard**

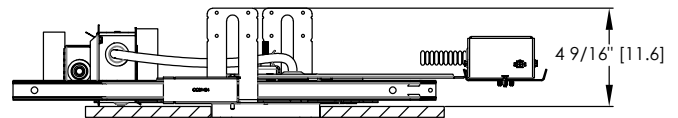
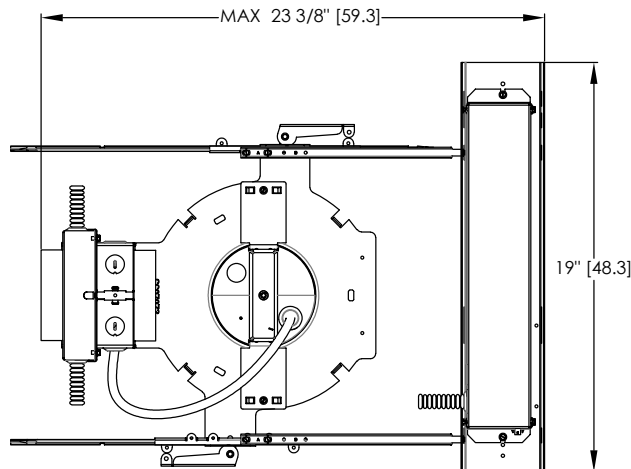

With Emergency Battery or GTD option

Minimum plenum height for emergency batteries in non-accessible ceilings: 12 1/2" [31.8]  
Ceiling thickness range: 1/2" [1.3] to 3" [7.6]  
Ceiling cutout: 5 1/16" [12.9]

\*Dimensions in inches [centimeters]

**RGH Double Driver CP Standard**

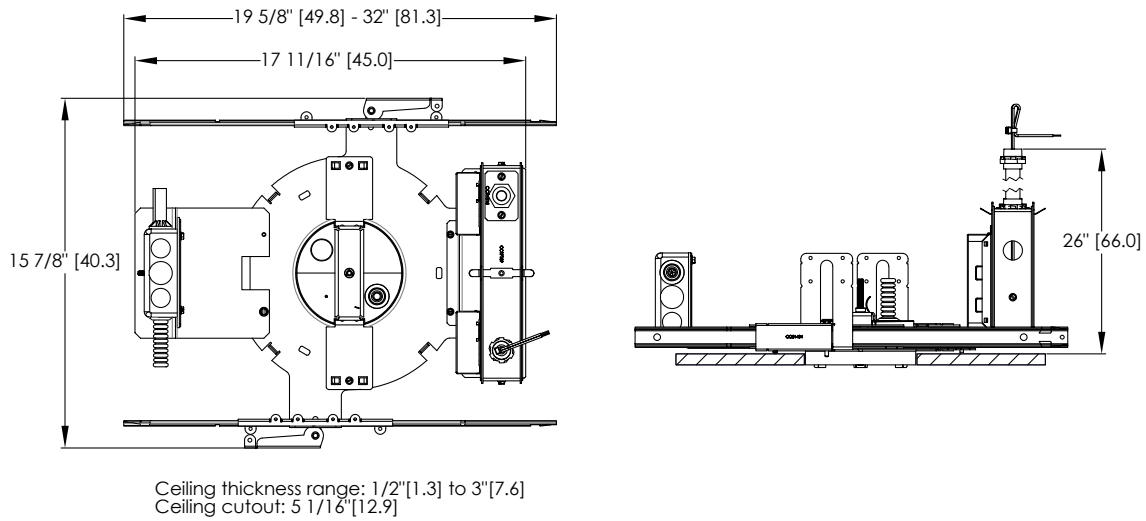

**RGH Double Driver with CP for use with 5000LM+ EDXB & ECOD, 6000LM & 8000LM Enclosed**

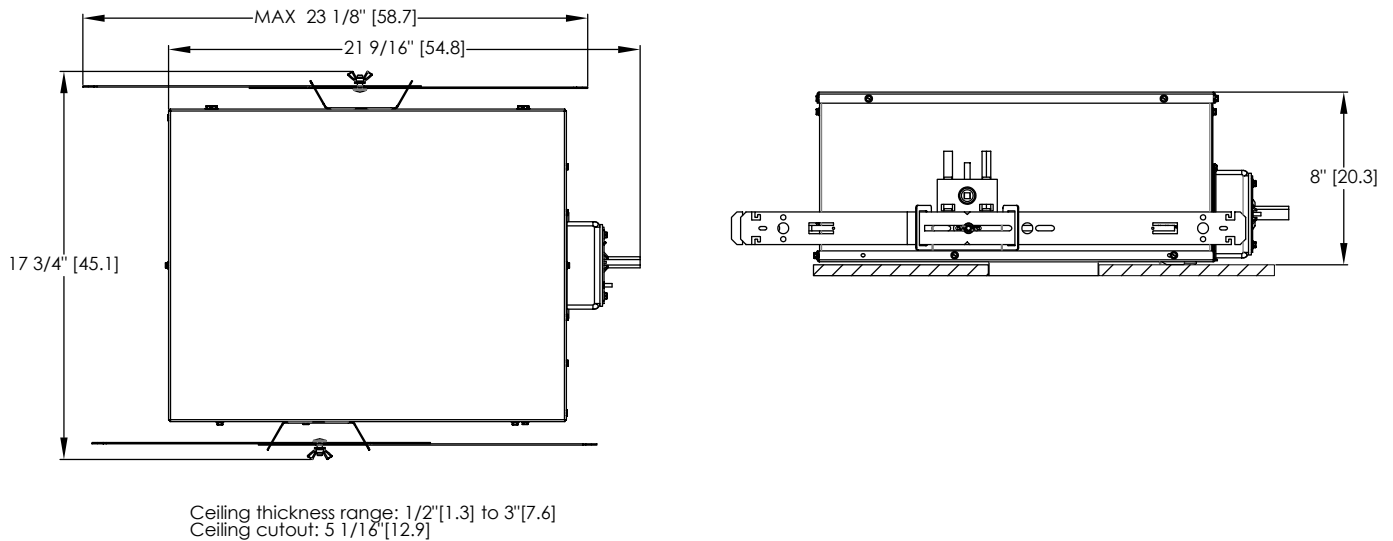

\*Dimensions in inches [centimeters]



CONSULT [WWW.GOTHAMLIGHTING.COM](http://WWW.GOTHAMLIGHTING.COM) FOR ADDITIONAL PHOTOMETRY.

**EVO6PC 35/15 AR MWD LS INPUT WATTS: 14.7, DELIVERED LUMENS: 1471LM, LPW= 100, 1.03 S/MH, TEST NO. LTL27783P**

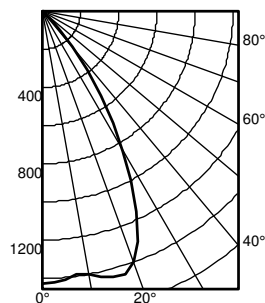

Ave	Lumens	Zone	Lumens	% Lamp
0	1431	0° - 30°	1061.4	72.2
5	1410	0° - 40°	1393.5	94.7
15	1442	0° - 60°	1469.5	99.9
25	1161	0° - 90°	1470.9	100.0
35	540	90° - 180°	0.0	0.0
45	78	0° - 180°	1470.9	*100.0
55	3			
65	1			
75	0			
85	0			
90	0			

\*Efficiency

		50% beam - 54.4°		10% beam - 77.9°	
		Initial FC			
Mounting Height	Center Beam	Diameter	FC	Diameter	FC
8.0	47.3	5.7	23.7	8.9	4.7
10.0	25.4	7.7	12.7	12.1	2.5
12.0	15.9	9.8	7.9	15.3	1.6
14.0	10.8	11.8	5.4	18.6	1.1
16.0	7.9	13.9	3.9	21.8	0.8

**EVO6PC 35/45 AR MWD LS INPUT WATTS: 47.3, DELIVERED LUMENS: 4532.7LM, LPW= 95.8, 1.03 S/MH, TEST NO. LTL27783P**

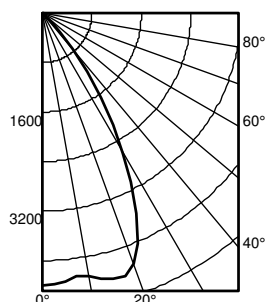

Ave	Lumens	Zone	Lumens	% Lamp
0	4411	0° - 30°	3270.7	72.2
5	4346	0° - 40°	4294.2	94.7
15	4443	0° - 60°	4528.3	99.9
25	3578	0° - 90°	4532.7	100.0
35	1665	90° - 180°	0.0	0.0
45	242	0° - 180°	4532.7	*100.0
55	8			
65	2			
75	1			
85	0			
90	0			

\*Efficiency

		50% beam - 54.4°		10% beam - 77.9°	
		Initial FC			
Mounting Height	Center Beam	Diameter	FC	Diameter	FC
8.0	145.8	5.7	72.9	8.9	14.6
10.0	78.4	7.7	39.2	12.1	7.8
12.0	48.9	9.8	24.4	15.3	4.9
14.0	33.4	11.8	16.7	18.6	3.3
16.0	24.2	13.9	12.1	21.8	2.4

**EVO6PC 35/175 AR MWD LS INPUT WATTS: 175.3, DELIVERED LUMENS: 17801LM, LPW=101.5, 1.06 S/MH, TEST NO. ISF 34035P**

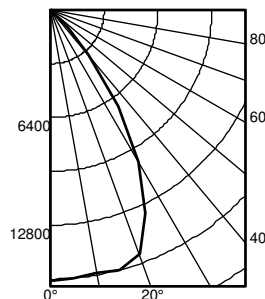

Ave	Lumens	Zone	Lumens	% Lamp
0	16146	0° - 30°	12002.3	67.4
5	15998	0° - 40°	16291.0	91.5
15	16006	0° - 60°	17746.3	99.7
25	13362	0° - 90°	17801.0	100.0
35	7018	90° - 120°	0.0	0.0
45	1470	90° - 130°	0.0	0.0
55	100	90° - 150°	0.0	0.0
65	37	90° - 180°	0.0	0.0
75	13	0° - 180°	17801.0	*100.0
85	2			
90	0			

\*Efficiency

		50% beam - 55.7°		10% beam - 79.8°	
		Initial FC			
Mounting Height	Center Beam	Diameter	FC	Diameter	FC
8.0	533.7	5.8	266.9	9.2	53.4
10.0	287.0	7.9	143.5	12.5	28.7
12.0	178.9	10.0	89.4	15.9	17.9
14.0	122.1	12.1	61.0	19.2	12.2
16.0	88.6	14.3	44.3	22.6	8.9

Lumen Output Multiplier		
CRI	CCT	Multiplier
80	2700K	0.916
	3000K	0.948
	3500K	1
	4000K	1.032
	5000K	1.1
90	2700K	0.748
	3000K	0.8
	3500K	0.838
	4000K	0.845
	5000K	0.945

Reflector Finish Multiplier	
Reflector Finish	Multiplier
LS - Specular	1
LSS - Semi Specular	0.956
WR - White	0.87
LD - Matte Diffuse	0.85
BR - Black	0.73
BZR - Bronze	0.73

Distributions		
Nomenclature	Beam Angle	Field Angle
VND	30	64
ND	44	69
MD	54	82
MWD	67	89
WD	71	92

nLight® AIR is the ideal solution for retrofit or new construction spaces where adding communication wiring is cost prohibitive. The integrated nLight AIR rPP20 Power Pack is part of each EVO Luminaire ordered with the NLTAIR option. These individually addressable controls offer the ultimate in flexibility during initial setup and for space repurposing.

#### nLight® AIR Control Accessories

Order as separate catalog number. Visit [nLight AIR](#).

##### Wall Switches

	Model Number
On/Off single pole	rPODB (color) G2
On/Off two pole	rPODB 2P (color) G2
On/Off & raise/lower single pole	rPODB DX (color) G2
On/Off & raise/lower two pole	rPODB 2P DX (color) G2

#### nLight® AIR Control Accessories (cont.)

##### Occupancy Sensors (PIR/dual tech)

	Model Number
Small motion 360°, ceiling	rCMS 9 / rCMS PDT 9
Large motion 360°, ceiling	rCMS 10 / rCMS PDT 10

#### UL924 Sequence of Operation

The below information applies to all nLight AIR devices with an EM option.

- EM devices will remain at their high-end trim and ignore wireless lighting control commands, unless a normal-power-sensed (NPS) broadcast is received at least every 8 seconds.
- Using the CLAIRITY™ mobile app, EM devices must be associated with a group that includes a normal power sensing device to receive NPS broadcasts.
- Only non-emergency rPP20, rLSXR, rSBOR, rSDGR, and nLight AIR luminaires with version 3.4 or later firmware can provide normal power sensing for EM devices. See specification sheets for control devices and luminaires for more information on options that support normal power sensing.

**nLight® Wired** The nLight® solution is a digital networked lighting control system that provides both energy savings and increased user configurability by cost effectively integrating time-based, daylight-based, sensor-based and manual lighting control schemes.

#### nLight® Wired Control Accessories

Order as separate catalog number. Visit [nLight](#).

##### Wall Switches

	Model Number
On/Off single pole	nPODM (color)
On/Off two pole	nPODM 2P (color)
On/Off & raise/lower single pole	nPOD DX (color)
On/Off & raise/lower two pole	nPODM 2P DX (color)
Graphic touchscreen	nPOD GFX (color)

##### Photocell Controls

Dimming	nCM ADCX
---------	----------

#### nLight® Wired Control Accessories (cont.)

##### Occupancy Sensors (PIR/dual tech)

	Model Number
Small motion 360°, ceiling	nCM 9 / nCM PDT 9
Large motion 360°, ceiling	nCM 10 / nCM PDT 10
Wide View	nWV 16 / nWV PDT 16
Wall switch with raise/lower	nWSX LV DX / nWSX PDT LV DX

##### Cat-5 Cables (plenum rated)

10', CAT5	CAT5 10FT J1
15', CAT5	CAT5 15FT J1

#### Possibilities for nLight® AIR

##### Fixtures ordered without the NLTAIR option

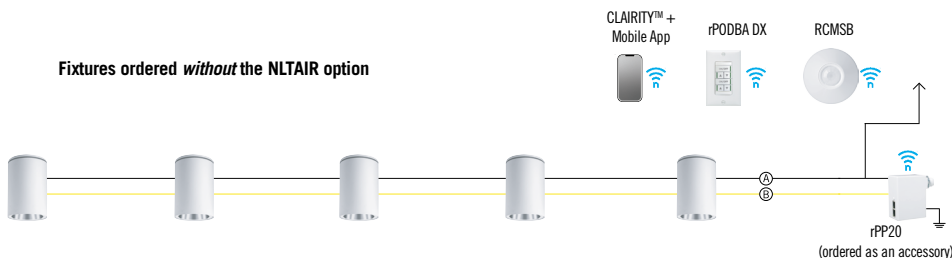

##### Fixtures ordered with the NLTAIR option

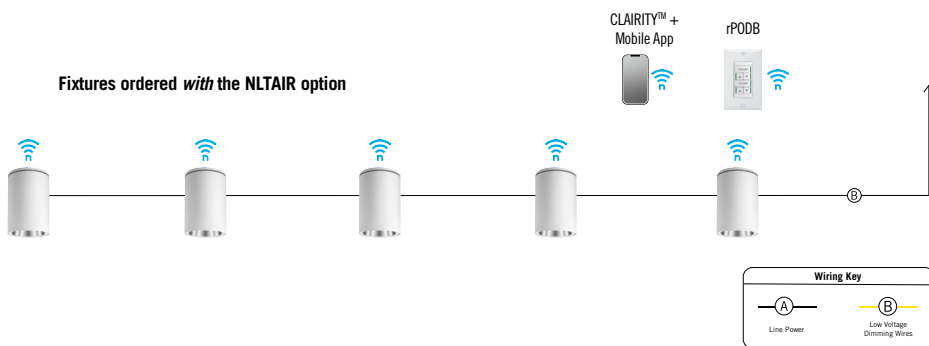

#### Possibilities for nLight® wired

##### Fixtures ordered without the NLT option

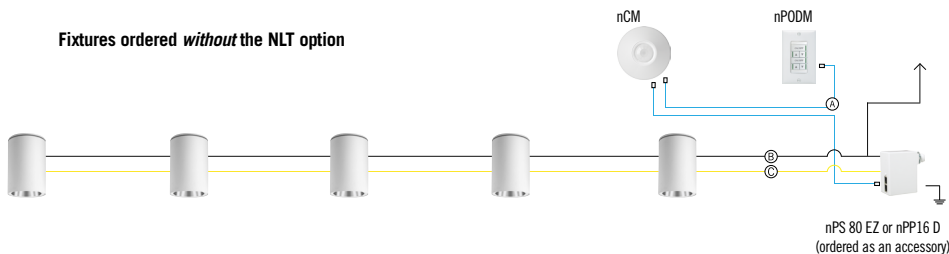

##### Fixtures ordered with the NLT option

